

Arc top panel holder



Alessandro Sardelli

[VIEW IN BROWSER](#)

updated 29. 6. 2023 | published 29. 6. 2023

Summary

A mod to the top left part of the ARC enclosure to hold the top panel when you don't need it.

[3D Printers](#) > [3D Printers - Upgrades](#)

I printed an ARC enclosure for my P1P. One of the most boring things is where to put the top panel when you don't need it (e.g. when you print PLA), so I modified one of the top parts of the ARC, adding a sort of pocket to hold it. It fits well and doesn't have any vibration problems. I put it on the left part of the printer but it is symmetrical, so you can also use it on the right side.

This remix is based on

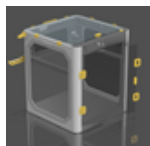

ARC Bambu Lab P1P Enclosure

by thrutheframe

Model files

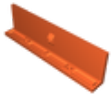

top-panel-holder.3mf

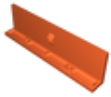

top-panel-holder.stl

License

This work is licensed under a
[Creative Commons \(4.0 International License\)](https://creativecommons.org/licenses/by-nc/4.0/)



Attribution-NonCommercial

-
- ✗ | Sharing without ATTRIBUTION
 - ✓ | Remix Culture allowed
 - ✗ | Commercial Use
 - ✗ | Free Cultural Works
 - ✗ | Meets Open Definition