



Ford Mustang Gen 6 (2015) Body Control Module (BCM) brackets

 **tiblu**

[VIEW IN BROWSER](#)

updated 29. 6. 2023 | published 29. 6. 2023

Summary

Ford Mustang Gen 6 (2015) Body Control Module (BCM) brackets for projects using said car as a donor.

[Hobby & Makers](#) > [Automotive](#)

Tags: [mustang](#) [restomod](#) [ford](#) [bracket](#) [bcm](#)

Ford Mustang Gen 6 (2015) Body Control Module (BCM) brackets

The BCM has slots, where these brackets clip in. You can use whichever of them in several positions depends on what your mounting points are going to be.

Probably Ford uses same BCM on many of their cars, so these brackets are not limited to Mustangs.

Originally created as a part of Ford Mustang 1965 fastback restomod which uses 2015 Mustang components - engine, PCM, BCM, BCM-B, RTM, SCCM, BJB, PATS front and rear antenna.

All questions and feedback welcome!
All modifications back to the community!

Model files



ford-bcm-clip-single.3mf

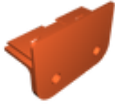

ford-bcm-clip-double.3mf

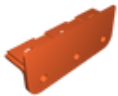

ford-bcm-clip-triple.3mf



ford-mustang-2015-bcm-mounting-clips-v4.f3d

License ©

This work is licensed under a
[Creative Commons \(4.0 International License\)](#)



Attribution—Noncommercial—Share Alike

- ✗ | Sharing without ATTRIBUTION
- ✓ | Remix Culture allowed
- ✗ | Commercial Use
- ✗ | Free Cultural Works
- ✗ | Meets Open Definition