

Prusa i3 MK3 ENCLOSURE -Ikea Lack table - Swiss edition

 **MonkeyMK**

[VIEW IN BROWSER](#)

updated 11. 9. 2023 | published 11. 9. 2023

Summary

A new version of the enclosure with Acrylic foil found in a swiss store (Jumbo).



44.80 hrs



10 pcs



0.25 mm
0.20 mm
0.30 mm



0.40 mm



PLA



769 g



Prusa MINI /
MINI+

[3D Printers](#) > [Accessories](#)

Tags: [mk3](#) [enclosure](#) [swiss](#)

I find out that Jumbo sells Acrylic foil that can be used to create a enclosure for the prusa MK3-4. If you don't want to cut them (because is not easy cut the acrylic without breaking it), I made this version of the enclosure that use a bigger Acrylic foil.

3Pz. Acrylic foil 500x500x3

<https://www.jumbo.ch/it/edilizia-rinnovare/materiali-da-copertura/lastre-a-doppia-parete/vetro-acrilico-500x500x3mm/p/6918624>

2Pz. Acrylic foil 500x250x3

<https://www.jumbo.ch/it/edilizia-rinnovare/materiali-da-copertura/lastre-a-doppia-parete/vetro-acrilico-250x500x3mm/p/6918623>

Hole Saw Ø50-55[mm]

Screw

Ø6 x 70 (4Pz.)

Ø3 x 20 (8Pz.) + 8Pz. For the foot

M8 x 30 (4Pz.) Hex head For the foot

This remix is based on



Original Prusa i3 MK3 ENCLOSURE -Ikea Lack table - Prusa Research

by Dominik Císař

Model files



Optional

5 files

staffal.stl



dadofilo.stl



piede.stl





basepiede.stl



forofilo.stl



basecono.stl



dadocavo.stl



cavo.stl



maniglial.stl



manigliar.stl



sedecalamite.stl



cernieraupl.stl



cernieraupr.stl



cernieradownr.stl



cernieradown.stl

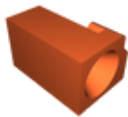

topconoportal.stl

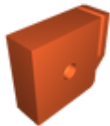

toptopoportar.stl



toptop.stl

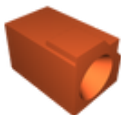

topcono.stl



toptopoportal.stl

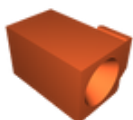

topconoportar.stl

Print files

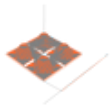

basecono_025mm_pla_mini_2h14m.gcode

🌀 PLA 📏 0.40 mm ⚖️ 0.25 mm ⌚ 2.23 hrs ⚖️ 34 g 🖨️ Prusa MINI / MINI+



cavo_02mm_pla_mini_6h54m.gcode

🌀 PLA 📏 0.40 mm ⚖️ 0.20 mm ⌚ 6.89 hrs ⚖️ 71 g 🖨️ Prusa MINI / MINI+



manigliat_025mm_pla_mini_2h50m.gcode

🌀 PLA 📏 0.40 mm ⚖️ 0.25 mm ⌚ 2.84 hrs ⚖️ 38 g 🖨️ Prusa MINI / MINI+



cernieradown_025mm_pla_mini_2h11m.gcode

🌀 PLA 📏 0.40 mm ⚖️ 0.25 mm ⌚ 2.19 hrs ⚖️ 29 g 🖨️ Prusa MINI / MINI+



cernieradown_03mm_pla_mk3_2h6m.gcode

🌀 PLA 📏 0.40 mm ⚖️ 0.30 mm ⌚ 2.10 hrs ⚖️ 33 g 🖨️ Prusa MK3/S/S+



topconoportal_03mm_pla_mk3_16h2m.gcode

🌀 PLA 📏 0.40 mm ⚖️ 0.30 mm ⌚ 16.03 hrs ⚖️ 371 g 🖨️ Prusa MK3/S/S+

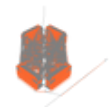

staffal_025mm_pla_mini_4h29m.gcode

🌀 PLA 📏 0.40 mm ⚖️ 0.25 mm ⌚ 4.48 hrs ⚖️ 75 g 🖨️ Prusa MINI / MINI+



dadofilo_025mm_pla_mini_2h59m.gcode

🌀 PLA 📏 0.40 mm ⚖️ 0.25 mm ⌚ 2.99 hrs ⚖️ 35 g 🖨️ Prusa MINI / MINI+



piede_04n_025mm_pla_mini_1h25m.gcode

PLA 0.40 mm 0.25 mm 1.42 hrs 28 g Prusa MINI / MINI+

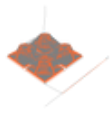

basepiede_04n_025mm_pla_mini_3h38m.gcode

PLA 0.40 mm 0.25 mm 3.63 hrs 55 g Prusa MINI / MINI+

License

This work is licensed under a
[Creative Commons \(4.0 International License\)](#)



Attribution-ShareAlike

- ✗ | Sharing without ATTRIBUTION
- ✓ | Remix Culture allowed
- ✓ | Commercial Use
- ✓ | Free Cultural Works
- ✓ | Meets Open Definition