

Z EndStop Adjustable Microswitch mount for HyperCube



EduGomes

[VIEW IN BROWSER](#)

updated 5. 7. 2023 | published 5. 7. 2023

Summary

Z EndStop Adjustable Microswitch mount for HyperCube

[3D Printers](#) > [3D Printers - Upgrades](#)

Tags: [thingiverse](#) [endstop](#) [adjustableendstop](#) [microswitch](#)

Z EndStop Adjustable Microswitch mount for HyperCube

Print Settings

Printer:

Hypercube Hevo

Rafts:

No

Supports:

Yes

Resolution:

0.15mm

Infill:

25%

Filament:

Generic PLA

any

Notes:

Category: 3D Printer Parts

Model files

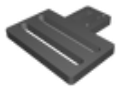

zendstop2.3mf

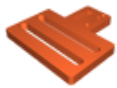

zendstop2.stl



zendstop3.stl



zendstop3.3mf



zendstop4.3mf



zendstop4.stl

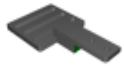

z_end_fixed3.3mf



z_end_fixed3.stl

[Find source .stl files on Thingiverse.com](#)

License ©

This work is licensed under a
Creative Commons (4.0 International License)



Attribution

-
- ✗ | Sharing without ATTRIBUTION
 - ✓ | Remix Culture allowed
 - ✓ | Commercial Use
 - ✓ | Free Cultural Works
 - ✓ | Meets Open Definition