



Xia Organizer with all Expansions

I Ibanous

[VIEW IN BROWSER](#)

updated 15. 1. 2021 | published 11. 1. 2021

Summary

An Organizer for Xia and all Expansions with cards sleeved. Fits in original box with very minor lid lift (1-2mm).

[Toys & Games](#) > [Boards Games](#)

Tags: [boardgameinsert](#) [boardgameorganizer](#) [xia](#)

An Organizer for Xia and all Expansions with cards sleeved. Fits in original box with very minor lid lift (1-2mm).

Print instructions

Most printed at .3 layer height with minimal infill ~10%.

Slicer wouldn't print the mesh on the ship boxes at .3 so either print at .2 or vary the layer height and print the mesh at a lower setting only.

I'm new to 3d modeling and all my STL seem to import facing the wrong way. Be sure to rotate onto the build plate. All print in the same orientation as they pack (note this means the ship boxes print with mesh backs on the build plate).

I only needed supports on the TierI ship holder and I had a hard time removing them. I recommend paint on supports only right around the U slot and configure your settings however needed to make removal easier.

Model files



tileholder.stl



tieriibox.stl



tokentray.stl



cardbox.stl

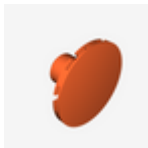

tieriholder.stl



componentblasterbox.stl



tieriibox.stl



astroidbox.stl



npcshipbox.stl



componentshieldbox.stl



componentboxmissile.stl



damagetray.stl



componentboxengine.stl

License



This work is licensed under a
Creative Commons (4.0 International License)

Attribution—Noncommercial—Share Alike

- ✗ | Sharing without ATTRIBUTION
- ✓ | Remix Culture allowed
- ✗ | Commercial Use
- ✗ | Free Cultural Works
- ✗ | Meets Open Definition