



## Camper Flash Drive



Derek

[VIEW IN BROWSER](#)

updated 19. 8. 2019 | published 19. 8. 2019

### Summary

To do multi color you'll need to look at the layers in your slicer and figure out when to switch filament.

[Gadgets](#) > [Computers](#)

Tags: [keychain](#) [housing](#) [camping](#) [camper](#) [flashdrive](#)

To do multi color you'll need to look at the layers in your slicer and figure out when to switch filament. I glued the center to 1 side, then glued the flash drive in place before gluing the final side. This allowed me to make sure it was exactly where i wanted it. Used a mini screw eye from a frame hanging kit for the actual keychain part. Cut the heads off 2 finishing nails and heated them up and pushed them through the final 2 holes for re-enforcement on the key chain.

### Model files

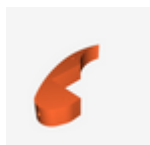

camper\_keychain\_middle.stl



camper\_keychain\_left.stl

---



camper\_keychain\_right.stl

---

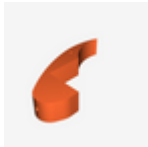

camper-keychain-thicker-middle-11\_3.stl

---

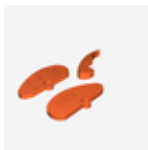

camper-keychain-complete.stl

---



camper-keychain-v2.stl

## License ©

This work is licensed under a  
[Creative Commons \(4.0 International License\)](#)



**Attribution—Noncommercial—No Derivatives**

---

- ✗ | Sharing without ATTRIBUTION
- ✗ | Remix Culture allowed
- ✗ | Commercial Use
- ✗ | Free Cultural Works
- ✗ | Meets Open Definition