

Aruba 305 86 box wall mount



chouchou

VIEW IN BROWSER

updated 1. 7. 2023 | published 1. 7. 2023

Summary

This only for Aruba 305, all other AP use vertical RJ45 connect, not suitable for wall mount.

[Costumes & Accessories](#) > [Other Costume Accessories](#)

This only for Aruba 305 AP. Other AP may have problem with RJ45 connector. So please check AP model before print. All file upload with step file, so you can edit it easily.

Aruba_AP_Mount.stl part need download on <https://www.thingiverse.com/thing:3363913>

BOM:

- M4 * 2 Screw for mount to 86 base box
- M3 * 2 Screw 8-15mm
- M3 * 4 heat threaded insert (outer diameter 4.2mm) for fix Aruba mount (You can edit step file suit your current have heat threaded insert)

Model files



aruba-305-86-wall-mount-base.3mf

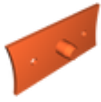

aruba-305-86-wall-mount-pin.3mf



86-box-wall-mount-for-305.step

License

This work is licensed under a
[Creative Commons \(4.0 International License\)](https://creativecommons.org/licenses/by/4.0/)



Attribution

- ✗ | Sharing without ATTRIBUTION
- ✓ | Remix Culture allowed
- ✓ | Commercial Use
- ✓ | Free Cultural Works
- ✓ | Meets Open Definition