



Pirates Treasure Chest



muddymaker

[VIEW IN BROWSER](#)

updated 24. 2. 2024 | published 24. 2. 2024

Summary

Pirates treasure chest.

[Hobby & Makers](#) > [Organizers](#)

Tags: [pirate](#) [treasurechest](#)

If you like my work and enjoy my models please consider leaving me a tip/donation, It helps me to continue creating awesome models for you for free.

<https://paypal.me/muddymaker>

UPDATE February 24th-Added optional side handles that are retrofittable. Simply superglue parts A + B into the provided holes in the corner pieces and superglue part C into A + B. No supports are needed, model files are in the correct print orientation.





UPDATE July 15th-Added a hasp lock and hinge system for those that want the option of locking their treasure from the world. Use a piece of 1.75mm filament for the hinge.

NB: If you have already printed this model prior to this update and want the hasp lock system, fear not, you don't have to reprint everything again. The hasp eye can be retrofitted to the front of the bottom by glueing it over the top of the pirate ship appliqué. For the old handle, just snap it off and clean the area up a little and then snap off the locating pins of the new hinge/handle and then glue it in place.

The girls wanted something, so here it is: <https://www.printables.com/model/521697-jewellery-chest>

UPDATE: July 2nd 2023-Added a boat wheel handle.

Pirates treasure chest. Somewhere to store all your loot matey.

External dimensions are L180mm W110mm H140mm

Internal dimensions are L164mm W94mm H110mm

You will require 2---20x6x2mm rectangular neodymium magnets.

You will need to print out,

1 bottom

1 bottom adornment

1 top adornment

4 corners

4 side trims

4 feet

2 pirate ships

2 skull & crossbones

4 palm trees (2 left facing & 2 right facing)

4 bands

2 swords

1 handle

1 top

Pause print @0.8mm on the sword files for the colour change.

Pause print @2.8mm on the palm trees, pirate ships and the skull and crossbones for the colour change.

Once you have all the printed parts, you need to superglue everything in this order;

BOTTOM

1. side trims

2. pirate ships, palm trees and skull & crossbones

3. bottom adornment

4. corner pieces

5. top adornment

TOP

1. swords

2. bands (NB: The shorter ends of the bands for the lid go towards the hinge side)

3. handle

Secure the top hinge with the bottom hinge with a piece of 1.75mm filament and trim to length and glue the ends.

The only part of this model that requires some supports is the underside of the top. I used organic supports in PrusaSlicer just for the very top of the underside and it left a very clean print.

Arrrrrgh happy printing matey.

Model files



bottom-adornment.stl



cornerx4.stl



top-adornment.stl



bottom.stl



side-trimx4.stl

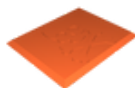

skull-crossbones-end-piece-x2.stl



pirate-ship-x2.stl



feet-x4.stl

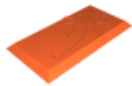

palm-tree-left-facing-x2.stl

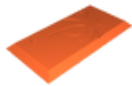

palm-tree-right-facing-x2.stl



swords-x2.stl

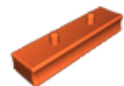

handle.stl

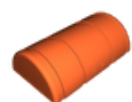

top.stl



band-x4.stl



boat-wheel-handle.stl



hasp.stl

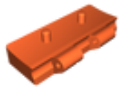

hinge.stl



hasp-eye.stl



side-handle-c.stl

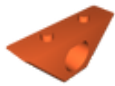

side-handle-b.stl

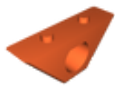

side-handle-a.stl

License ©

This work is licensed under a
[Creative Commons \(4.0 International License\)](#)



Attribution—Noncommercial—Share Alike

- ✗ | Sharing without ATTRIBUTION
- ✓ | Remix Culture allowed
- ✗ | Commercial Use
- ✗ | Free Cultural Works
- ✗ | Meets Open Definition