

## blade push for dog groomers



Alex

[VIEW IN BROWSER](#)

updated 2. 7. 2023 | published 2. 7. 2023

### Summary

i made this model for dog groomers who struggle with taking the blade apart due to stiffness

[World & Scans](#) > [Animals](#)

Tags: [dog](#) [dogs](#) [clippers](#) [groomers](#) [doggroomers](#)

this model is for all dog groomers who struggle to get those stiff blades apart.

I recommend 100% infill for push part and 20% for handle. scale to size of choice, make sure to join parts in slicer by letting them overlap. i would use a material that is not brittle like petg

### Model files

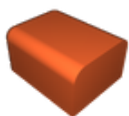

**blade\_push\_handle.stl**

☐ 20% infill recommend

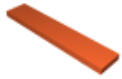

**push\_part.stl**

📄 100% infill recommend

## License ©

This work is licensed under a  
**Creative Commons (4.0 International License)**



### Attribution

---

- ✗ | Sharing without ATTRIBUTION
- ✓ | Remix Culture allowed
- ✓ | Commercial Use
- ✓ | Free Cultural Works
- ✓ | Meets Open Definition