

RatRig Panel Due i7 screen holder

 Senelis910

[VIEW IN BROWSER](#)

updated 1. 7. 2023 | published 1. 7. 2023

Summary

This is my remix for RatRig Panel Due i7 adaptor using friction to stay in desired place.

[3D Printers](#) > [3D Printers - Upgrades](#)

Tags: [paneldue7](#) [paneldue7i](#) [panelmount](#) [ratrigvcore3](#)
[mountingbracket](#) [ratrig](#) [holder](#) [duetpanel](#) [paneldue](#) [7i](#)
[duet](#) [panelduecase](#) [panel](#) [mount](#) [duetwifi](#) [duetpaneldue](#)

This is my remix for RatRig Panel Due i7 adaptor using friction to stay in desired place.

Recommended plastic: PETG/ABS/ASA.

Required hardware:

1. For mounting the screen bezel to the case and the Pane Due to the bezel. 8x M3x8mm

Flat Head Thread-forming Screws

1. These are for assembling the swivel arm mount. Tighten the M5 screw until there is enough tension to hold the assembly together, but loose enough that it can rotate.

1x M5x20mm Flanged Socket-head Screw
1x 9.5x7.5mm O.D. Spring
1x M5 Nyloc Nut

1. For attaching the pivot arm to the Case

4x M4x8mm Flat Head Screws
4x M4 Nyloc Nuts

This remix is based on



Duet Panel Due 7i Pendant for RatRig VCore3

by Zedicuss803

Model files

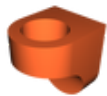

pivot_holder.stl



strain_relief.stl



frame_attachement.stl

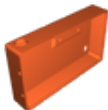

real_case.stl



front_bezel.stl



hinge_arm.stl

License ©

This work is licensed under a
[Creative Commons \(4.0 International License\)](#)



Attribution

- ✗ | Sharing without ATTRIBUTION
- ✓ | Remix Culture allowed
- ✓ | Commercial Use
- ✓ | Free Cultural Works
- ✓ | Meets Open Definition