



Winnie the Pooh - MMU



reddadsteve

[VIEW IN BROWSER](#)

updated 22. 8. 2019 | published 22. 8. 2019

Summary

MMU version of Winnie-the-Pooh, also called Pooh Bear, is a fictional anthropomorphic teddy bear created by English...

[Toys & Games](#) > [Action Figures & Statues](#)

Tags: [animal](#) [bear](#)

MMU version of Winnie-the-Pooh, also called Pooh Bear, is a fictional anthropomorphic teddy bear created by English author A. A. Milne.

A. A. Milne named the character Winnie-the-Pooh after a teddy bear owned by his son, Christopher Robin Milne, who was the basis for the character Christopher Robin. The rest of Christopher Robin Milne's toys – Piglet, Eeyore, Kanga, Roo, and Tigger – were incorporated into Milne's stories. Two more characters, Owl and Rabbit, were created by Milne's imagination, while Gopher was added to the Disney version.

The model, as presented is 60mm tall.

This MMU model was derived from my non-MMU model (reworked for a clean MMU print and 'only' five colors):

<https://www.prusaprinters.org/prints/219-winnie-the-pooh>
and

<https://www.prusaprinters.org/prints/5181-winnie-the-pooh-smooth>

Enjoy! And don't forget to post your makes.

Print instructions

The 3MF file contains all the parameters I used for the Prusa Slicer.

I've also included all the STL files in case you use a different slicer.

The supplied files are for the smallest recommended size of the model. The model can be sized up without issue, but I would not recommend sizing it down any further.

Note; Two files are listed as light brown (ltbrown). The Prusa MMU is limited to 5 colors so I made the top and bottom of the jar the same light brown color, but if you have the capability of six colors this gives you the option of making the jar two separate colors like the original.

Model files



winnie.3mf



3_black.stl



5_ltbrowna.stl



5_ltbrownb.stl

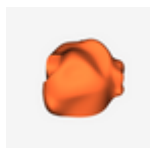

4_yellow.stl

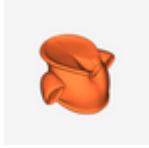

2_red.stl



1_skin.stl

License

This work is licensed under a
[Creative Commons \(4.0 International License\)](https://creativecommons.org/licenses/by-nc-sa/4.0/)



Attribution—Noncommercial—Share Alike

- ✗ | Sharing without ATTRIBUTION
- ✓ | Remix Culture allowed
- ✗ | Commercial Use
- ✗ | Free Cultural Works
- ✗ | Meets Open Definition