



Winnie the Pooh - Smooth



reddadsteve

[VIEW IN BROWSER](#)

updated 19. 8. 2019 | published 19. 8. 2019

Summary

After posting my original Winnie the Pooh with 'fur' a number of people requested a 'smooth' version.

[Toys & Games](#) > [Action Figures & Statues](#)

Tags: [animal](#) [bear](#)

After posting my original Winnie the Pooh with 'fur' a number of people requested a 'smooth' version.

I've included all the parts for the full build under this remake for simplicity. All of my build notes (colors, print and assembly suggestions) can be found with the original model:

<https://www.prusaprinters.org/prints/219-winnie-the-pooh>

Enjoy!

Model files



eye_right.stl



arm_left_smooth.stl



eyebrow_right.stl



eye_left.stl

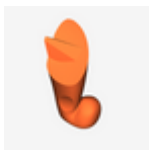

leg_left_smooth.stl

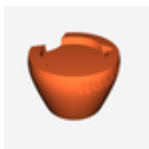

jar_bottom.stl



head_smooth.stl



leg_right_smooth.stl

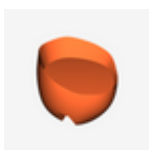

body_smooth.stl

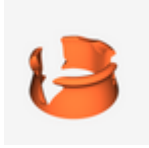

jar_top.stl



nose.stl



sleeve_left.stl



honey.stl



eyebrow_left.stl



tongue.stl

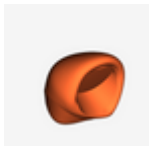

sleeve_right.stl

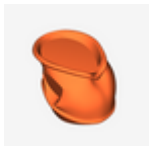

shirt.stl



hunny_text.stl



arm_right_smooth.stl

License

This work is licensed under a
Creative Commons (4.0 International License)



Attribution—Noncommercial—Share Alike

- ✗ | Sharing without ATTRIBUTION
- ✓ | Remix Culture allowed
- ✗ | Commercial Use
- ✗ | Free Cultural Works
- ✗ | Meets Open Definition