



Spool Holder for Custom Dry Box System



Don

[VIEW IN BROWSER](#)

updated 2. 7. 2023 | published 2. 7. 2023

Summary

This is a basic spool holder design for a custom filament dry box storage system that I am currently developing.

[3D Printers](#) > [Accessories](#)

This is a basic spool holder design for a custom filament dry box storage system that I am currently developing. It can also be used as a loose filament supply stand for the printer. I will be adding other features to this model as development progresses.

Recommended: Low-Normal quality at the basic settings for PLA or PetG depending on what you prefer. This is designed to be printed as quickly and cheaply as possible and put into use with some minimal post processing (if you aren't good at preventing travel stringing with your slicer).

Designed in Tinkercad.

I printed this one on my Longer LK1, Using Sunlu PLA and the following settings:

- 70C Bed Temperature
- 205C .04-Nozzle Temperature
- Low Quality, no supports on the base, only touching base supports on the roller; and with retraction of 5.0 mm.

- Sliced in Ultimaker Cura 5.1

Model files

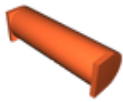

spindle_002.stl



spool_stand.stl

License ©

This work is licensed under a
[Creative Commons \(4.0 International License\)](#)



Attribution-ShareAlike

-
- ✗ | Sharing without ATTRIBUTION
 - ✓ | Remix Culture allowed
 - ✓ | Commercial Use
 - ✓ | Free Cultural Works
 - ✓ | Meets Open Definition