



Off-Road Semi Truck



P-atix

[VIEW IN BROWSER](#)

updated 7. 7. 2023 | published 7. 7. 2023

Summary

Off-Road Semi Truck



39.21 hrs



16 pcs



0.30 mm



0.40 mm



PLA



770 g



Prusa
MK3/S/S+

[Toys & Games](#) > [Vehicles](#)

Tags:

4wd

offroad

toy

semi

scalemodel

car

truck

Off-Road Semi Truck

Based on Fiat 65PC truck (1975)

The truck has functional suspension and a proper wheels for overcoming obstacles.

Every part has been adjusted for smooth supportless printing.

Keep the orientation of the parts as shown on the picture in help.pdf !

The whole model is bolted together with **(30x) M3x16mm and four M3x40mm.**

Read help.pdf for assembly (download other files)

The cab was pre-supported.

If you want to make your own supports, a file without them is included.

Printer setup:

Nozzle diameter 0,4

Layer height 0.30mm

10% infill

No supports

Model files



01_cab-sup.stl



01_cab.stl



02_frame.stl



03_tire.stl



04_tire-m.stl



05_wheel.stl

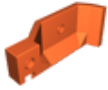

06_fender.stl



07_fender-m.stl



08_spring.stl



09_spring-m.stl



010_axle.stl

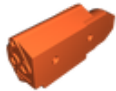

011_engine-block.stl

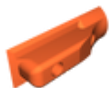

012_engine-oil.stl



013_shaft.stl

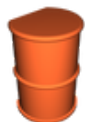

014_tank.stl



015_-exhaust.stl



016_door-v1.stl



017_door-v2.stl



018_container-v1.stl

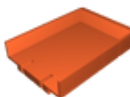

019_container-v2.stl

Print files



01_cab-sup_03mm_pla_mk3s_6h32m.gcode

⚙️ PLA ⚙️ 0.40 mm ⚙️ 0.30 mm ⌚ 6.53 hrs ⚖️ 101 g 🖨️ Prusa MK3/S/S+

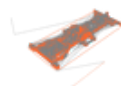

02_frame_03mm_pla_mk3s_3h26m.gcode

⚙️ PLA ⚙️ 0.40 mm ⚙️ 0.30 mm ⌚ 3.43 hrs ⚖️ 59 g 🖨️ Prusa MK3/S/S+



03_tire_03mm_pla_mk3s_3h36m.gcode

⚙️ PLA ⚙️ 0.40 mm ⚙️ 0.30 mm ⌚ 3.60 hrs ⚖️ 64 g 🖨️ Prusa MK3/S/S+



05_wheel_03mm_pla_mk3s_1h23m.gcode

⚙️ PLA ⚙️ 0.40 mm ⚙️ 0.30 mm ⌚ 1.39 hrs ⚖️ 21 g 🖨️ Prusa MK3/S/S+



06_fender_03mm_pla_mk3s_1h1m.gcode

🌀 PLA 🌀 0.40 mm ≡ 0.30 mm ⌚ 1.01 hrs ⚖️ 19 g 📄 Prusa MK3/S/S+



08_spring_03mm_pla_mk3s_48m.gcode

🌀 PLA 🌀 0.40 mm ≡ 0.30 mm ⌚ 0.80 hrs ⚖️ 10 g 📄 Prusa MK3/S/S+



010_axle_03mm_pla_mk3s_44m.gcode

🌀 PLA 🌀 0.40 mm ≡ 0.30 mm ⌚ 0.74 hrs ⚖️ 12 g 📄 Prusa MK3/S/S+



011_engine-block_03mm_pla_mk3s_43m.gcode

🌀 PLA 🌀 0.40 mm ≡ 0.30 mm ⌚ 0.71 hrs ⚖️ 11 g 📄 Prusa MK3/S/S+



012_engine-oil_03mm_pla_mk3s_17m.gcode

🌀 PLA 🌀 0.40 mm ≡ 0.30 mm ⌚ 0.29 hrs ⚖️ 4 g 📄 Prusa MK3/S/S+



013_shaft_03mm_pla_mk3s_33m.gcode

🌀 PLA 🌀 0.40 mm ≡ 0.30 mm ⌚ 0.55 hrs ⚖️ 9 g 📄 Prusa MK3/S/S+



014_tank_03mm_pla_mk3s_57m.gcode

🌀 PLA 🌀 0.40 mm ≡ 0.30 mm ⌚ 0.95 hrs ⚖️ 16 g 📄 Prusa MK3/S/S+



015_-exhaust_03mm_pla_mk3s_24m.gcode

🌀 PLA 🌀 0.40 mm ≡ 0.30 mm ⌚ 0.40 hrs ⚖️ 3 g 📄 Prusa MK3/S/S+



016_door-v1_03mm_pla_mk3s_1h17m.gcode

🌀 PLA 🌀 0.40 mm ≡ 0.30 mm ⌚ 1.29 hrs ⚖️ 28 g 📄 Prusa MK3/S/S+



017_door-v2_03mm_pla_mk3s_38m.gcode

🌀 PLA 📏 0.40 mm ⚖️ 0.30 mm ⌚ 0.64 hrs ⚖️ 11 g 🖨️ Prusa MK3/S/S+



018_container-v1_03mm_pla_mk3s_11h4m.gcode

🌀 PLA 📏 0.40 mm ⚖️ 0.30 mm ⌚ 11.06 hrs ⚖️ 267 g 🖨️ Prusa MK3/S/S+



019_container-v2_03mm_pla_mk3s_5h49m.gcode

🌀 PLA 📏 0.40 mm ⚖️ 0.30 mm ⌚ 5.82 hrs ⚖️ 135 g 🖨️ Prusa MK3/S/S+

Other files



help.pdf

License

This work is licensed under a
[Creative Commons \(4.0 International License\)](#)



Attribution—Noncommercial—No Derivatives

- ✗ | Sharing without ATTRIBUTION
- ✗ | Remix Culture allowed
- ✗ | Commercial Use
- ✗ | Free Cultural Works
- ✗ | Meets Open Definition