



WPC95 Pinball Speaker Adapter

latenite04

[VIEW IN BROWSER](#)

updated 3. 7. 2023 | published 3. 7. 2023

Summary

Speaker mounts for WPC95 plastic dmd panels. There are remakes of the originals as well as a 4" adapter and a 4"...

[Toys & Games](#) > [Outdoor Toys](#)

Tags: [pinball](#) [pinballparts](#) [thingiverse](#)

Speaker mounts for WPC95 plastic dmd panels. There are remakes of the originals as well as a 4" adapter and a 4" adapter with space for led strips. I used the post screw washers with some plastic screws to replace the metal pal nuts that used to hold on the speaker panel.

Print Settings

Printer Brand:

Creality

Printer:

CR-10

Rafts:

No

Supports:

No

Resolution:

0.2

Infill:

20%

Filament: Solutech 3d pla Black

Category: Toy & Game Accessories

Model files



wpc95_4_inch_led_speaker_plate.stl



wpc95_4_inch_led_speaker_back_plate.stl



wpc95_large_speaker_plate.stl



wpc95_small_speaker_plate.stl



wpc95speakerplate.scad



wpc95_4_inch_speaker_plate.stl

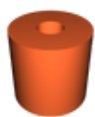

wpc95_post_screw_washer.stl

[Find source .stl files on Thingiverse.com](#)

License ©

This work is licensed under a
Creative Commons (4.0 International License)



Attribution-NonCommercial

-
- ✗ | Sharing without ATTRIBUTION
 - ✓ | Remix Culture allowed
 - ✗ | Commercial Use
 - ✗ | Free Cultural Works
 - ✗ | Meets Open Definition