



Kotlin Amazon Peccy



Matas Lauzadis

[VIEW IN BROWSER](#)

updated 7. 10. 2023 | published 7. 10. 2023

Summary

An artistic model combining the Kotlin programming language logo with Amazon's mascot Peccy

[Art & Design](#) > [Sculptures](#)

Tags: [amazon](#) [kotlin](#) [peccy](#)

The Kotlin logo and Peccy head are joined together with magnets.

Model files



magnet-test-plate.stl

☐ Use this to test if your magnets will fit in the parts

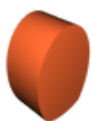

peccy-pupil.stl



peccy-eyeball.stl

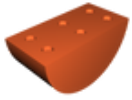

peccy-head.stl



middle-orange.stl



top-blue.stl



connecting-pin.stl

☐ Pin used to connect the different pieces together



bottom-blue.stl

License ©

This work is licensed under a
[Creative Commons \(International License\)](#)



Public Domain

- ✓ | Sharing without ATTRIBUTION
- ✓ | Remix Culture allowed
- ✓ | Commercial Use
- ✓ | Free Cultural Works
- ✓ | Meets Open Definition

