



## Quick Release Barbell Collar / Barbell Clip for 2" bar

[VIEW IN BROWSER](#)

updated 10. 10. 2023 | published 10. 10. 2023

## Summary

Olympic Barbell collar/clamp Design with a print-in-place hinge for the open/close mechanism.

[Sports & Outdoor](#) > [Indoor Sports](#)

Tags: [collar](#) [clamp](#) [weightlifting](#) [barbell](#)

Quick release Barbell Collar/Clamp for a 2" bar.  
Current design requires 4x #6 1" construction screws.  
Print 1x:

cylinder.stl, clamp.stl

Print 2x:

part-1.stl, part-2.stl, tpu.stl (I printed in TPU but you can print in PLA)  
The clamp is a print-in-place hinge.

# Model files

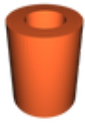

cylinder.stl

---

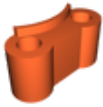

tpu.stl

---



part-1-final.stl

---



part-2-final.stl

---



clamp.stl

## License

This work is licensed under a  
[Creative Commons \(4.0 International License\)](https://creativecommons.org/licenses/by-nc-sa/4.0/)



**Attribution—Noncommercial—Share Alike**

---

- ✗ | Sharing without ATTRIBUTION
- ✓ | Remix Culture allowed
- ✗ | Commercial Use
- ✗ | Free Cultural Works
- ✗ | Meets Open Definition

