

Rebate & Dado Markout tool



hijakd

[VIEW IN BROWSER](#)

updated 8. 10. 2023 | published 8. 10. 2023

Summary

A cabinet markout tool for 17mm marine/form work Plywood



1.32 hrs



1 pcs



0.30 mm



0.40 mm



PLA



24 g



Creality
CR-X Pro

[Hobby & Makers](#) > [Tools](#)

Tags: [marking](#) [markingtool](#) [measuring](#) [speedsquare](#)
[markingguide](#) [markingtools](#)

This is a first version of the tool.

I designed this tool for marking out the dados and rebates of a shelving cabinet I need to build using 17mm plywood boards.

The intention is to be able to use this in the same manner as a speed square, both left & right handed, and to mark out lengths and widths, butting the long side ends to the edge of the material gives you the reference point.

The total length is 100mm, the mark out steps have a 0.5mm clearance, ie;

- the first step is 9.5mm from the butt to give a 9mm rebate
- the second step 9mm wide by 8.5mm deep, to give an 8mm wide dado

I intend to add markings for the measurements and a second dado step for an additional reference point when marking out.

Model files

rebate_dado_markout_tool.3mf

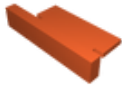

rebate_dado_markout_tool.stl

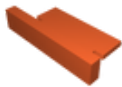

Print files

crx_rebate_dado_markout_tool.gcode



PLA 0.40 mm 0.30 mm 1.32 hrs 24 g

License ©

This work is licensed under a
[Creative Commons \(4.0 International License\)](#)



Attribution—Noncommercial—Share Alike

✗ | Sharing without ATTRIBUTION

- ✓ | Remix Culture allowed
- ✗ | Commercial Use
- ✗ | Free Cultural Works
- ✗ | Meets Open Definition