



Ikea Frame Repair - Universal Mounting Hook for Ribba



Chrise_2000

[VIEW IN BROWSER](#)

updated 8. 10. 2023 | published 8. 10. 2023

Summary

Ensure your Ribba Frames are always flush against the wall with this improve design

[Household](#) > [Home Decor](#)

Tags: [wall](#) [ikea](#) [frame](#) [picture](#) [upcycle](#) [support](#)
[wallmount](#) [bracket](#) [mountingbracket](#) [hooks](#)

Restore your Old Ikea Frames with this universal Ribba Frame Mount

Scaled hook ensures frame rests always flush against the wall.

Consistant marking distance to top of frame (circa 27mm)

Easy to level

Fits all frame sizes

I secured with strong gorilla glue - rivit mount possible with provided 4mm holes.

Model files

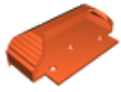

ikea-ribba-hook.stl

License



This work is licensed under a
[Creative Commons \(4.0 International License\)](https://creativecommons.org/licenses/by-nc-sa/4.0/)

Attribution—Noncommercial—Share Alike

-
- ✗ | Sharing without ATTRIBUTION
 - ✓ | Remix Culture allowed
 - ✗ | Commercial Use
 - ✗ | Free Cultural Works
 - ✗ | Meets Open Definition