

Chair locking



Lexikon

[VIEW IN BROWSER](#)

updated 8. 10. 2023 | published 8. 10. 2023

Summary

Blokovací mechanismus pro židle s kolečky. Locking mechanism for chairs with wheels.

[Gadgets](#) > [Video Games](#)

Tags: [wheels](#) [chair](#) [locking](#) [zidle](#) [aretace](#)

(CZ) Tento model je vhodný pro ty, kteří rádi hrají PC hry s volantem a pedály. Pod židli si můžete dát tuto aretaci, a židle bude stát na místě jako přibitá.

Je to modelováno na \varnothing kolečka 50 mm a šířku 50 mm.

Popis jak a na čem jsem tiskl:

Tiskárna: Prusa I3 Mk3S

Materiál: PETG

Tiskový profil: Prusa PETG

Tryska: 0.4

Vrstva: 0.3 Draft

Výplň: 20%

Podpory: Ne

(EN) "This model is suitable for those who enjoy playing PC games with a steering wheel and pedals. You can attach this locking mechanism under your chair, and the chair will stay in place like it's nailed down.

It is designed for Ø 50mm wheels with a width of 50mm.

Description of how and on what I printed:

Printer: Prusa I3 Mk3S

Material: PETG

Printing Profile: Prusa PETG

Nozzle: 0.4

Layer: 0.3 Draft

Infill: 20%

Supports: None

Model files

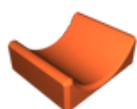

aretace-kresla.stl

License

This work is licensed under a
[Creative Commons \(4.0 International License\)](#)



Attribution

✖ | Sharing without ATTRIBUTION

- ✓ | Remix Culture allowed
- ✓ | Commercial Use
- ✓ | Free Cultural Works
- ✓ | Meets Open Definition