

Holder for loading mobile devices

 markardt

[VIEW IN BROWSER](#)

updated 8. 10. 2023 | published 8. 10. 2023

Summary

Wall mounted holder for mobile devices - makes sure that they dont fall down during charging process ;)

[Household](#) > [Other House Equipment](#)

Tags: [holder](#) [wallmount](#) [charger](#) [charging](#) [wallmounted](#)
[loudspeaker](#) [thingiverse](#) [mobilephoneholder](#) [mobilephone](#)
[usbcharger](#) [mobiledeviceholder](#) [mobiledevice](#)

Wall mounted holder for mobile devices - makes sure that they dont fall down during charging process ;)

Print Settings

Printer:

myPrinter

Rafts:

No

Supports:

Yes

Resolution:

I used 0,15

Infill:

15%

Filament:

any brand you like ASA, PLA, PETG

feel free

Notes:

I used ASA for printing and a lot of sandpaper to make it smooth - using ASA I highly recommend and heated enclosure - else better use PLA or PETG

Category: Household

Model files

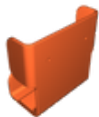

loadingstation.stl

[Find source .stl files on Thingiverse.com](#)

License ©

This work is licensed under a
[Creative Commons \(4.0 International License\)](#)



Attribution-NonCommercial

-
- ✗ | Sharing without ATTRIBUTION
 - ✓ | Remix Culture allowed

- ✖ | Commercial Use
- ✖ | Free Cultural Works
- ✖ | Meets Open Definition