



Eiffel tower 30 cm (four parts) - with lighting

[VIEW IN BROWSER](#)

updated 9. 10. 2023 | published 9. 10. 2023

Summary

It really is, with lighting and that's not a joke.



24.21 hrs



4 pcs



0.20 mm



0.40 mm



PLA



251 g



Prusa
MK3/S/S+

[World & Scans](#) > [Architecture & Urbanism](#)

Tags: [led](#) [eiffel](#) [lighting](#) [eiffeltower](#) [eiffeltowerparis](#)

It's a story. A few weeks ago we were in Paris and everywhere you could buy expensive models of the Eiffel Tower and some even flashed. So I promised the family that I would print it for them and it would be lit. :)

Since I used the add hollow body slicer functions, it is not possible to add STL files, only projects and you can export gcode from them as needed. Use the other parts of the tower from the model by Tiques77. The tip of the tower must be drilled with a 4 mm diameter wood drill.

For lighting, I used a pepco Home decorative led chain with a length of 10 m and 100 LEDs (the image is in the photo gallery).

I wound a large part of the chain on the coaxial cable and thus created a cylinder that I inserted into the long part of the tower, I placed the rest on the body of the Eiffel Tower, trying not to show the wiring.

I won't say here that it was easy, but as you can see, it is possible. So the proverb applies: There is no way it can't be done, I just don't want to. :)

As the icing on the cake, I created a pedestal in which the power source (battery) is hidden.

This remix is based on



Tour Eiffel (quatre pièces)/ Eiffel tower 30 cm (four parts)

by Tiques77

Model files

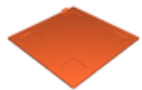

base_cover.stl

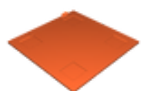

base_cover.3mf

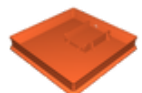

lower_part_of_the_base.stl

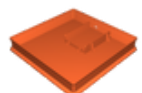

lower_part_of_the_base.3mf



eiffel_tower_milieu_haut_light.3mf



eiffel_tower_milieu_bas_light.3mf

Print files



base_cover_02mm_pla_mk3s_4h15m.gcode

PLA 0.40 mm 0.20 mm 4.25 hrs 67 g Prusa MK3/S/S+



lower_part_of_the_base_02mm_pla_mk3s_8h13m.gcode

PLA 0.40 mm 0.20 mm 8.21 hrs 123 g Prusa MK3/S/S+



eiffel_tower_milieu_haut_light_pla_6h40m_02mm.gcode

PLA 0.40 mm 0.20 mm 6.67 hrs 29 g Prusa MK3/S/S+

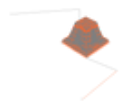

eiffel_tower_milieu_bas_light_pla_5h5m_02mm.gcode

PLA 0.40 mm 0.20 mm 5.08 hrs 32 g Prusa MK3/S/S+

License

This work is licensed under a
[Creative Commons \(4.0 International License\)](https://creativecommons.org/licenses/by-sa/4.0/)

Attribution-ShareAlike



- ✗ | Sharing without ATTRIBUTION
- ✓ | Remix Culture allowed
- ✓ | Commercial Use
- ✓ | Free Cultural Works
- ✓ | Meets Open Definition