



Bumbálka mountain hut (kit) 1:100 / Horská chata Bumbálka (stavebnice) 1:100

 Jiří Šilhavík

[VIEW IN BROWSER](#)

updated 10. 10. 2023 | published 10. 10. 2023

Summary

Chata Bumbálka postavená v letech 1934-35 na pomezí Česka a Slovenska



34.79 hrs



11 pcs



0.20 mm



0.40 mm



PET



409 g



Prusa MINI /
MINI+

[Toys & Games](#) > [Building Toys](#)

Tags: [building](#) [set](#) [hut](#) [stavebnice](#)

Model of the Bumbálka mountain hut - designed and built in 1934-1935 by Robert Seifert from Jablunkov. The mountain hut is located in the Beskydy Mountains on the border of the Czech Republic and Slovakia. Due to (not very noticeable) construction modifications, today it no longer looks as nice as in the past.

Model horské chaty Bumbálka navržené a postavené v letech 1934-1935 Robertem Seifertem z Jablunkova. Horská chata se nachází v pohoří

Beskyd na pomezí Česka a Slovenska. Vlivem (ne příliš citelných) stavebních úprav dnes již nevypadá tak pěkně jako v minulosti.

Model files

	stl	28 files
	strecha.stl	
	strecha-podkrovi-3-ks.stl	
	schodiste.stl	
	terasa.stl	
	hlavni-budova-h.stl	
	hlavni-budova-p.stl	
	hlavni-budova-d.stl	

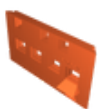

hlavni-budova-l.stl



spojka-4-ks.stl



okno-schody-male-6-ks.3mf



okno-stredni-1-ks.3mf



okno-schody-velke-3-ks.stl



okno-schody-male-6-ks.stl



okno-prostredni-11-ks.stl



okno-male-9-ks.stl



okno-stredni-6-ks.stl



okno-uzke-2-ks.stl



okno-velke-15-ks.3mf



sklo-prostredni-11-ks.stl



sklo-schody-male-6-ks.stl



sklo-uzke-2-ks.stl



sklo-male-9-ks.stl



sklo-stredni-6-ks.stl



okno-velke-15-ks.stl



sklo-schody-velke-3-ks.stl



sklo-velke-15-ks.stl



vchodove-dvere.stl



vikyr-3-ks.stl



3mf

11 files



strecha.3mf



strecha-podkrovi-3-ks.3mf



schodiste.3mf



terasa.3mf



hlavni-budova-h.3mf



hlavni-budova-p.3mf

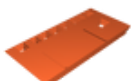

hlavni-budova-d.3mf



hlavni-budova-l.3mf

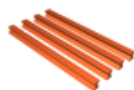

spojka-4-ks.3mf



vyplne-otvoru.3mf



sklenene-vyplne.3mf

Print files



strecha_02mm_petg_mini_12h59m.gcode

PET 0.40 mm 0.20 mm 12.98 hrs 155 g Prusa MINI / MINI+



strecha-podkrovi-3-ks_02mm_petg_mini_1h14m.gcode

PET 0.40 mm 0.20 mm 1.23 hrs 16 g Prusa MINI / MINI+



schodiste_02mm_petg_mini_3h54m.gcode

PET 0.40 mm 0.20 mm 3.90 hrs 38 g Prusa MINI / MINI+



terasa_02mm_petg_mini_3h56m.gcode

PET 0.40 mm 0.20 mm 3.94 hrs 41 g Prusa MINI / MINI+



hlavni-budova-h_02mm_petg_mini_2h45m.gcode

PET 0.40 mm 0.20 mm 2.75 hrs 38 g Prusa MINI / MINI+



hlavni-budova-p_02mm_petg_mini_2h36m.gcode

PET 0.40 mm 0.20 mm 2.61 hrs 35 g Prusa MINI / MINI+

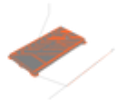

hlavni-budova-d_02mm_petg_mini_2h42m.gcode

PET 0.40 mm 0.20 mm 2.70 hrs 36 g Prusa MINI / MINI+

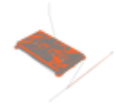

hlavni-budova-l_02mm_petg_mini_2h46m.gcode

PET 0.40 mm 0.20 mm 2.77 hrs 35 g Prusa MINI / MINI+



spojka-4-ks_02mm_petg_mini_22m.gcode

PET 0.40 mm 0.20 mm 0.36 hrs 4 g Prusa MINI / MINI+

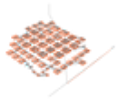

vyplne-otvoru_02mm_petg_mini_1h3m.gcode

PET 0.40 mm 0.20 mm 1.04 hrs 7 g Prusa MINI / MINI+

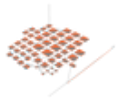

sklenene-vyplne_02mm_petg_mini_31m.gcode

PET 0.40 mm 0.20 mm 0.51 hrs 4 g Prusa MINI / MINI+

License

This work is licensed under a
[Creative Commons \(4.0 International License\)](https://creativecommons.org/licenses/by/4.0/)

Attribution



- ✖ | Sharing without ATTRIBUTION
- ✔ | Remix Culture allowed
- ✔ | Commercial Use
- ✔ | Free Cultural Works
- ✔ | Meets Open Definition