

3D MODEL ONLY

120x120 fan fitting to KG100 pipe



PaŠe

[VIEW IN BROWSER](#)

updated 8. 10. 2023 | published 8. 10. 2023

Summary

An adapter for connection of 120x120 fan to KG100 pipe

[Hobby & Makers](#) > [Electronics](#)

Wall insert to be printed with pause for insert 6xM4 regular nuts

Model files



fanfitting-cableclamppocket003.stl

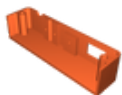

fanfitting-switchcoverpocket002.stl



fanfitting-wallinsert.stl

License

This work is licensed under a
GNU



General Public License v2.0

- ✗ | Sharing without ATTRIBUTION
- ✓ | Remix Culture allowed
- ✓ | Commercial Use
- ✓ | Meets Open Definition
- i | Share under the same license