

Parametric Miniature Base Storage for HSW

B Bluewind Minis

[VIEW IN BROWSER](#)

updated 9. 10. 2023 | published 9. 10. 2023

Summary

Includes an scad file and some stl presets.

[Hobby & Makers](#) > [Organizers](#)

Tags: [miniature](#) [storage](#) [scalemodel](#) [miniaturepainting](#)
[miniaturebase](#) [honeycombstoragewall](#) [honeycombwall](#)

You can alter the following:

- The diameter of base to accomodate
- The length of the container
- The width of the walls
- Whether to use a hex peg for a hollow insert or a screw hole
 - The size of head and thread of the screw
 - The tolerance for the screw hole

The version with a screw hole shouldn't need any supports.

This remix is based on



Honeycomb storage wall

by RostaP

Model files



base-holder.scad

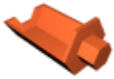

base-holder-28mm.stl

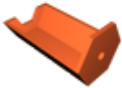

base-holder-25mm-m4.stl



base-holder-25mm.stl



base-holder-32mm.stl

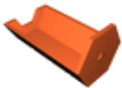

base-holder-28mm-m4.stl



base-holder-32mm-m4.stl

License

This work is licensed under a
Creative Commons (4.0 International License)



Attribution-NonCommercial

- ✗ | Sharing without ATTRIBUTION
- ✓ | Remix Culture allowed
- ✗ | Commercial Use
- ✗ | Free Cultural Works
- ✗ | Meets Open Definition