



Magnetic Tiles Haunted House: Railings, Pillars, Arches & Beams



3DPmom

[VIEW IN BROWSER](#)

updated 9. 10. 2023 | published 9. 10. 2023

Summary

Here are the railing, pillar, arch and beam pieces for the magnetic tile haunted house.

[Learning](#) > [Engineering](#)

Tags: [halloween](#) [magnet](#) [magnetic](#) [hauntedhouse](#)
[magnetstick](#) [magnatile](#) [3dpmom](#) [3dpmagnatiles](#)
[3dphauntedhouse](#) [3dpmagnetic](#) [3dpmagnetictiles](#)

Here are the railing, pillar, arch and beam pieces for the magnetic tile haunted house.

General information for all these pieces:

PLA Filament

Layer height 0.2mm

Infill 15-20%

No supports needed (see recommendations for brims below)

Neodymium magnets needed for arches and railings: 20x5x2 and 10x5x2.

Neodymium magnet size need for pillars: 12x5x3 **OR** 10x5x2

Magnetic build plate highly recommended but not absolutely necessary.

Arches

Neodymium magnets sizes needed for the arches: 20x5x2 and 10x5x2 (I strongly recommend using these size magnets. If you go larger it may not allow the magnets to rotate within their chambers.)

I recommend brims for the arches to prevent warping at edges.

For the arches, add a pause print at layer height 6.0mm to insert the magnets. When the print is paused insert the magnets. I like to alternate these two size magnets between the magnets holes (20x5x2, 10x5x2, 20x5x2, 10x5x2, etc.). I found if I used all 20x5x2 they were too strong and if I used all 10x5x2 it felt a little too weak.

After the magnets are inserted, resume the print.

Railings

Neodymium magnet size need for railings: 20x5x2 and 10x5x2

Brim is not needed for the railings.

Add a pause print at layer height 6.2mm to insert the magnets. I like 20x5x2 for the magnets at the bottom of the railing and 10x5x2 for the magnets along the side of left and right railings. Insert magnets, then resume print.

Pillars

I recommend a brim for the pillar body/base piece because it is tall. The brim will help add stability.

Add a pause print at layer height 6.0 mm to insert the magnets. Insert magnets, then resume print. That's it:)

Here is a link to Amazon for the magnets needed for this print:

<https://www.amazon.com/shop/3dpmom>

Model files

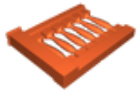

porch-left-railing.stl

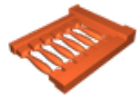

porch-right-railing.stl

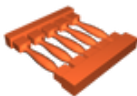

porch-side-railing.stl



base-body-of-pillar.stl

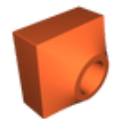

top-of-pillar.stl



magtile-arch-150x150.stl



magtile-150x150-arch-with-notch-for-beam.stl



beam-for-150x150-arch.stl

License ©

