



## Qube 500 Tray/Pot Customizer (Vase Mode)



1sPiRe

[VIEW IN BROWSER](#)

updated 9. 10. 2023 | published 9. 10. 2023

## Summary

This is a Tray/Pot Openscad's customizer based on the matrix holes of the Qube 500

[Gadgets](#) > [Computers](#)

Tags: [parametric](#) [customizable](#) [easy](#) [customized](#) [easyprint](#)

This trays and pots use pegs to slide on. As this pegs are a bit tricky to print I added a more easy-to-print version.

There is 2 types of objects : Tray and Pot

And there is 2 print options : Vase mode or Wall mode

## HOW TO USE OPENS CAD

- Download and install latest version of Openscad [here](#). This is an opensource light software (21MB).
- Download the \*.scad file and open it with Openscad
- Play with the values in the customizer panel (if it is hide go to view/hide customizer)

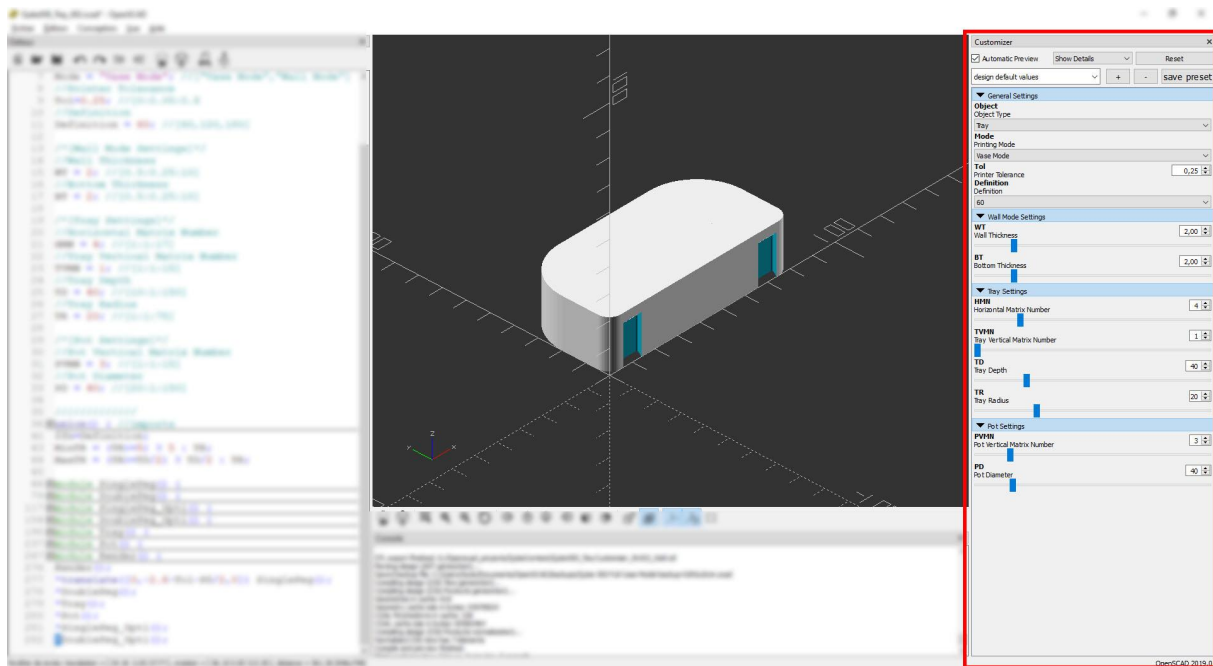

- Once you find the values you want/need, press F6 to render...and then F7 to export as STL.

## Model files

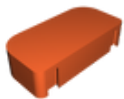

**qube500\_traycustomizer\_tray01\_vase.stl**

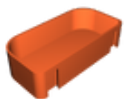

**qube500\_traycustomizer\_tray01\_wall.stl**



**qube500\_traycustomizer\_singlepeg.stl**



**qube500\_traycustomizer\_singlepegopti.stl**



**qube500\_traycustomizer\_doublepeg.stl**

---



**qube500\_traycustomizer\_doublepegopti.stl**

---

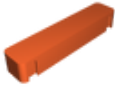

**qube500\_traycustomizer\_tray02\_vase.stl**

---

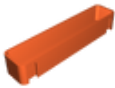

**qube500\_traycustomizer\_tray02\_wall.stl**

---



**qube500\_traycustomizer\_tray03\_vase.stl**

---



**qube500\_traycustomizer\_tray03\_wall.stl**

---



**qube500\_traycustomizer\_pot02\_vase.stl**

---



**qube500\_traycustomizer\_pot02\_wall.stl**

---



**qube500\_traycustomizer\_pot01\_wall.stl**

---



**qube500\_traycustomizer\_pot01\_vase.stl**

---



qube500\_traycustomizer.scad

## License

This work is licensed under a  
**Creative Commons (4.0 International License)**



**Attribution-ShareAlike**

- 
- ✗ | Sharing without ATTRIBUTION
  - ✓ | Remix Culture allowed
  - ✓ | Commercial Use
  - ✓ | Free Cultural Works
  - ✓ | Meets Open Definition