



Towel hook with pop-up name



DT07

[VIEW IN BROWSER](#)

updated 6. 1. 2024 | published 6. 1. 2024

Summary

Towel hook with pop-up name



N/A



2 pcs



0.20 mm
0.30 mm



0.60 mm



PLA



N/A



Prusa
MK3/S/S+

[Household](#) > [Bathroom](#)

Tags: [holder](#) [bathroom](#) [bathroomorganizer](#) [popup](#)
[towelhook](#) [bathroomaccessories](#) [bathroomaccessory](#)

I designed this Towel hook with personalized pop-up name.

The cover with the name appears when a towel is hanged up and disappears when it is removed.

Step 1: print all parts



The base and the screw support must be printed standing with a 10mm brim at 0mm of distance otherwise they will detach from the print bed.

See the picture:

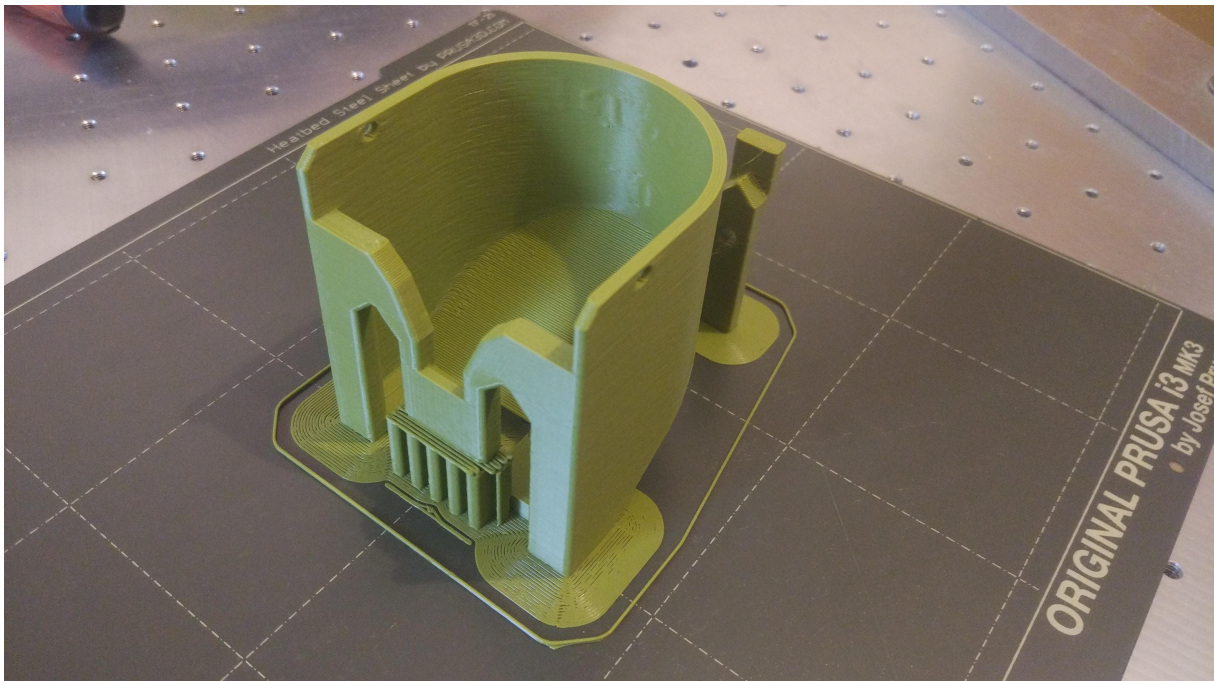

Infill 25% , Layer maximum 0.3 mm and support only where shown in the photo.

Step 2: Screw a 4x20mm screw to hold the hook in place.



Make sure that the hook is free to move



Step3 : Insert the hook into the base observing these movements, or it will not fit.

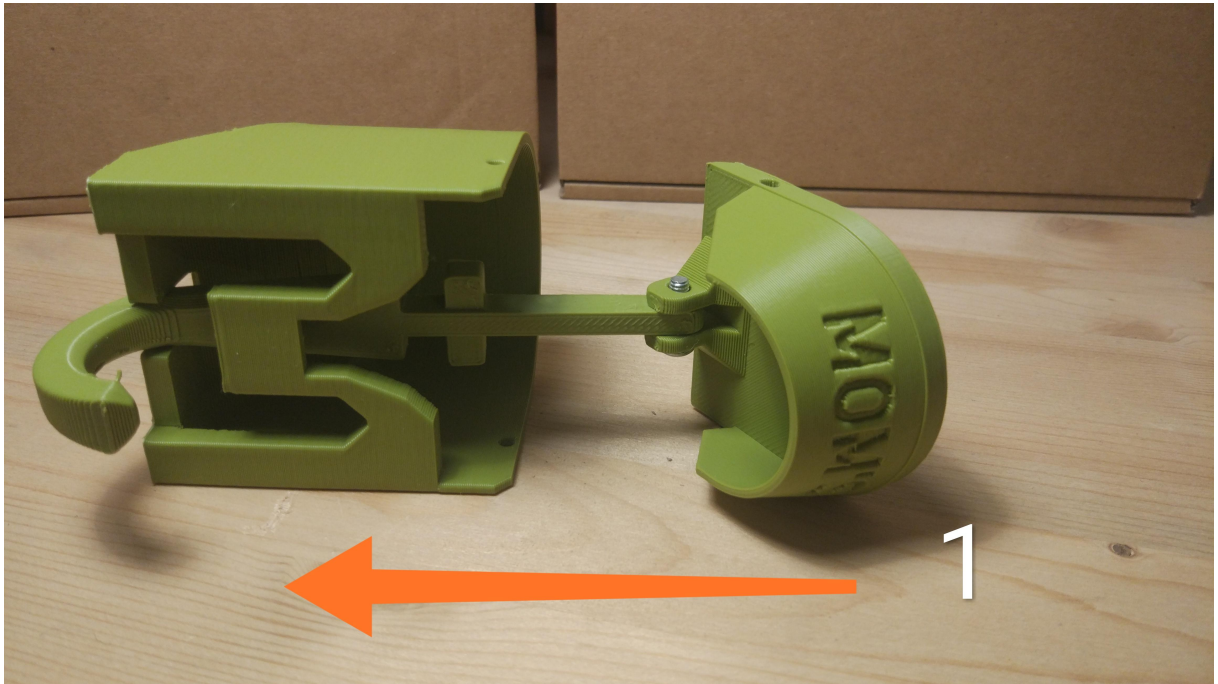
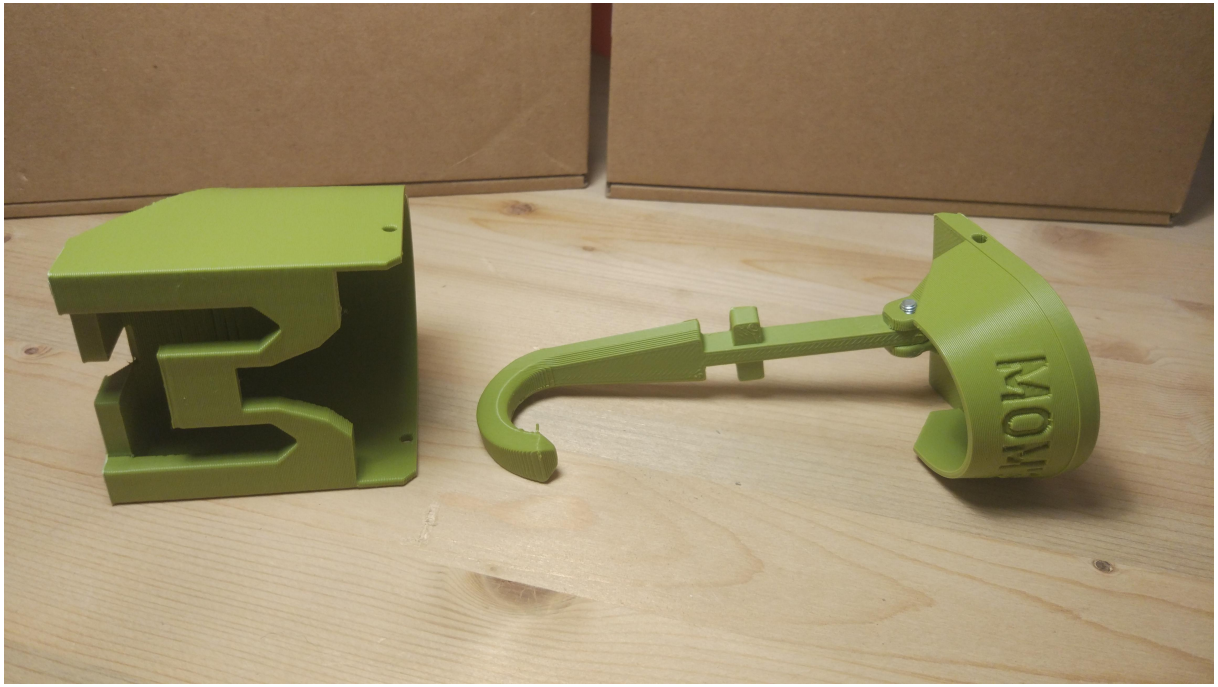

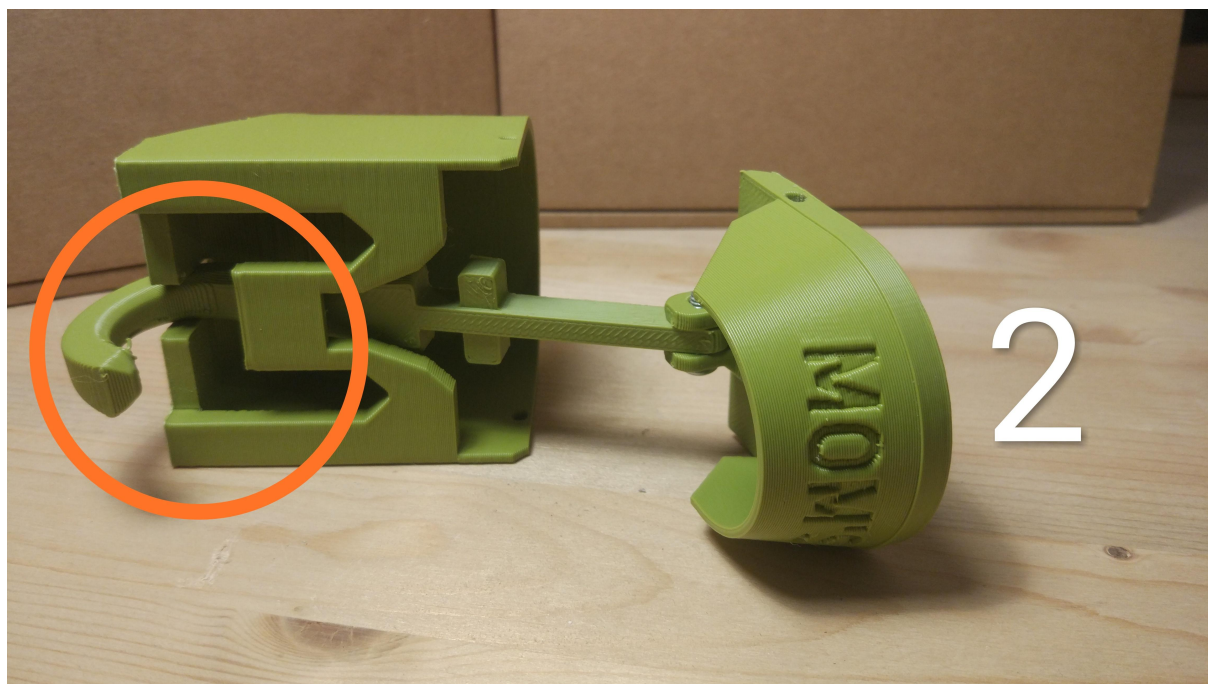

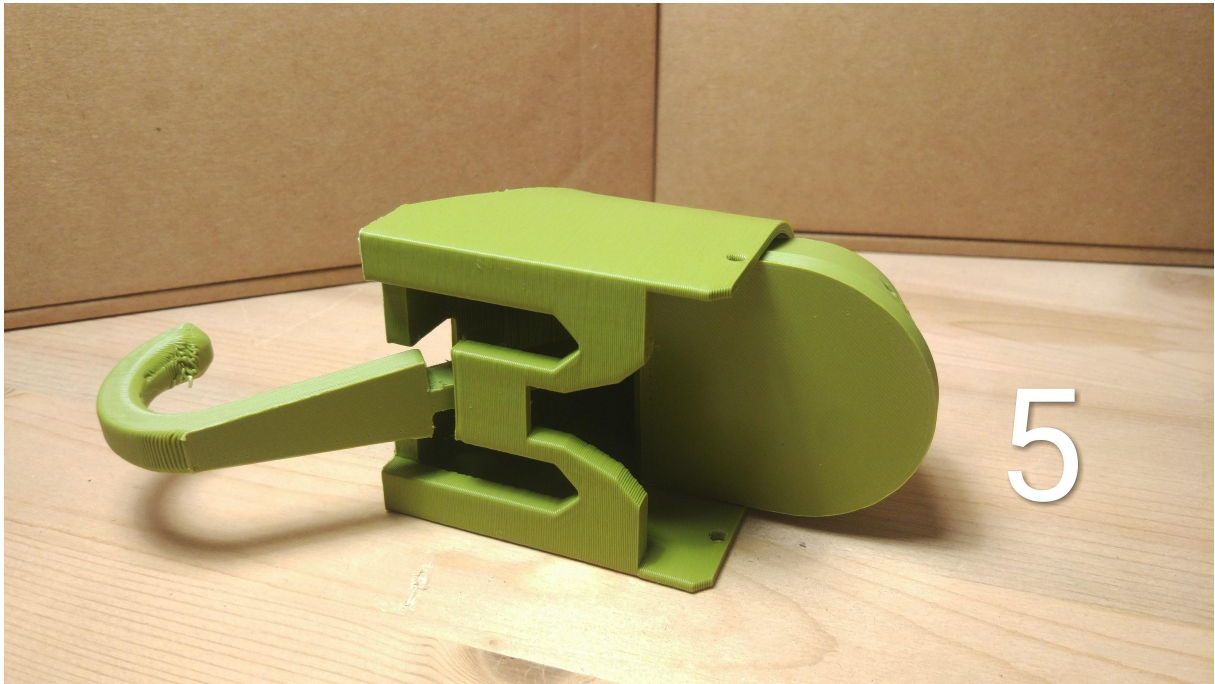
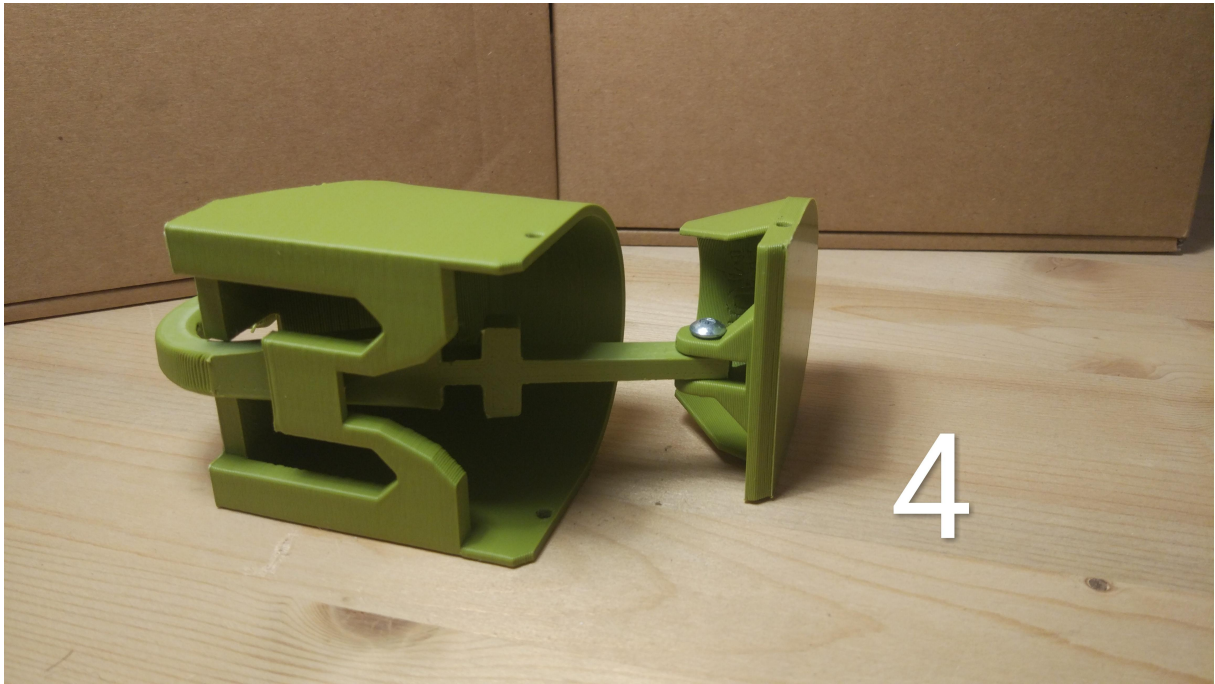

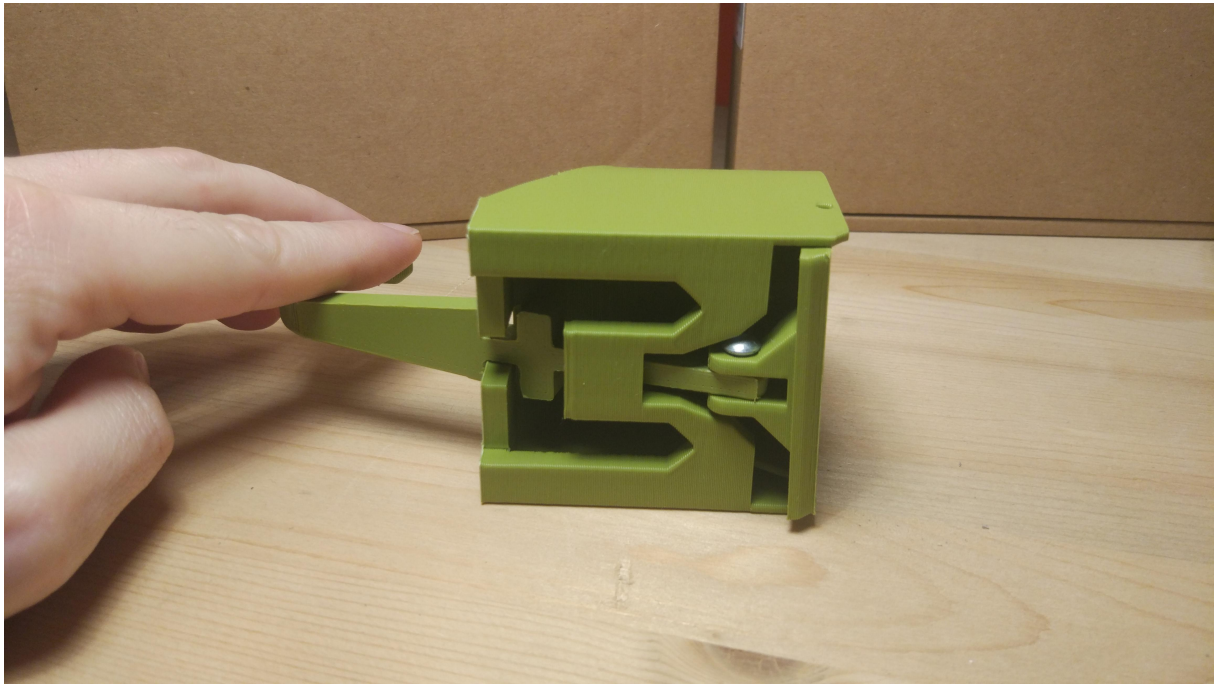

Step 4: Fix the cover with 3x16 mm screws:

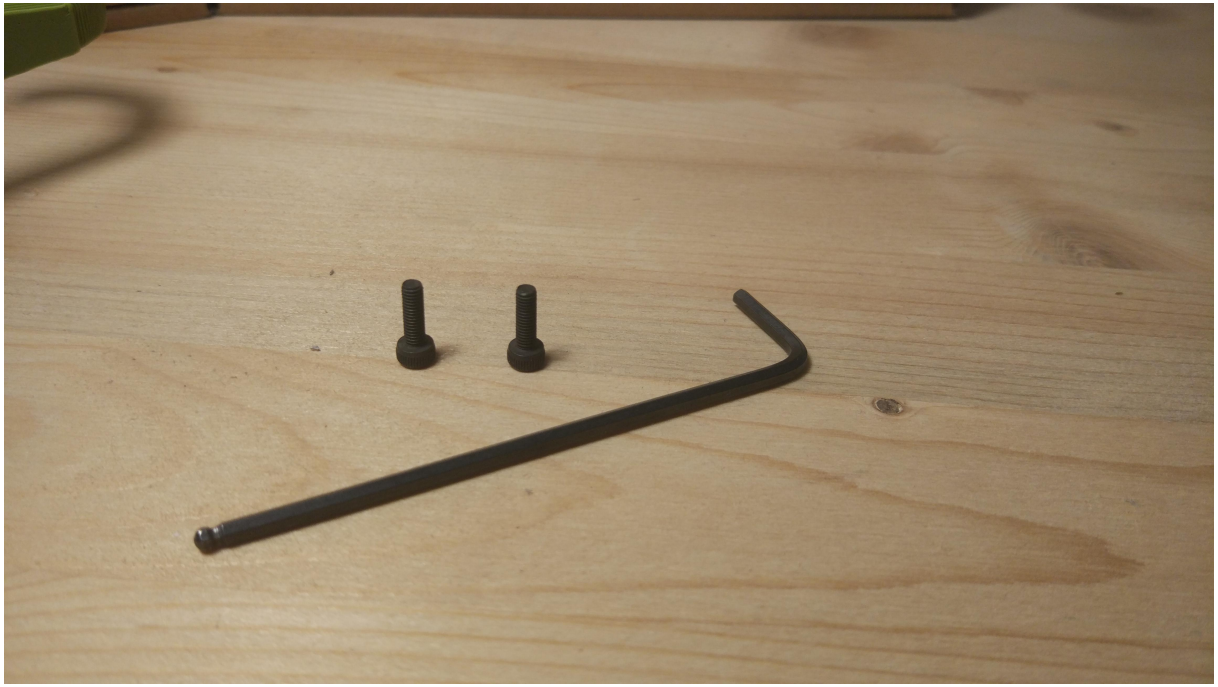



The cover should open and close without friction.

Step 5: Find the right screws to mount the stand on the wall and secure it.

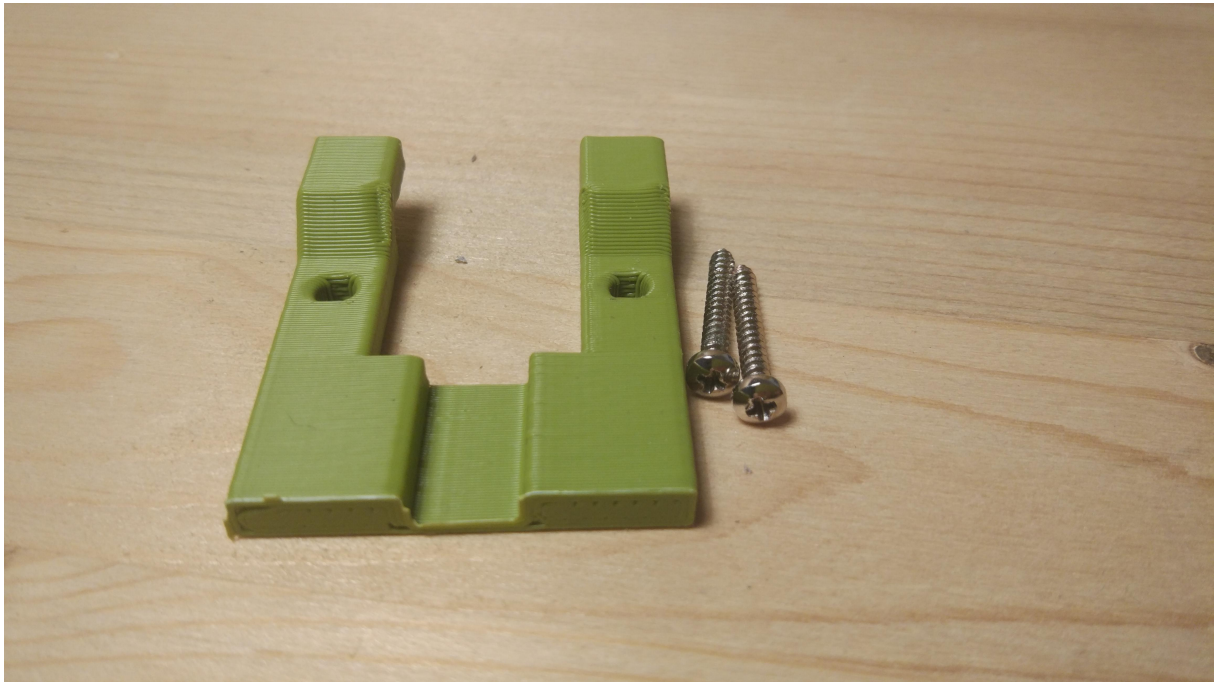



Step 6: Insert the base into the support.

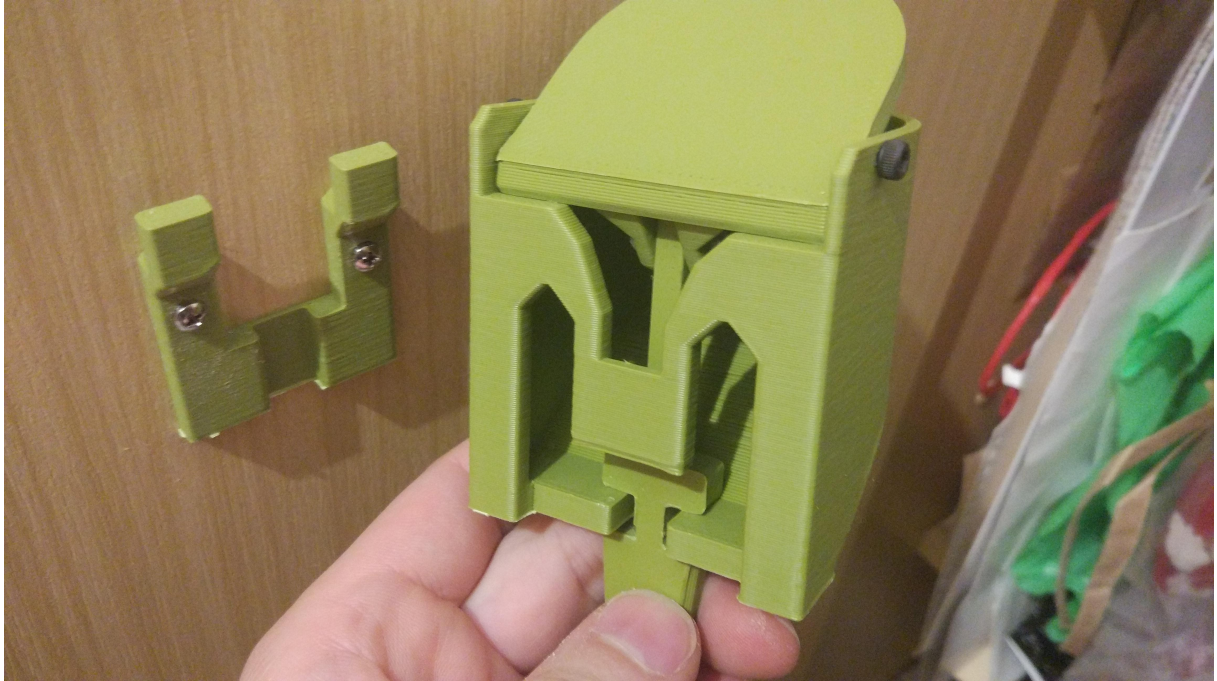

Finish!

You can hang your towel on your custom hook!





If you want to change the name, you need to modify the file in Fusion 360.

Download the Fusion360 file and follow this steps.

Right-click on the "Cover write" sketch and select modify.

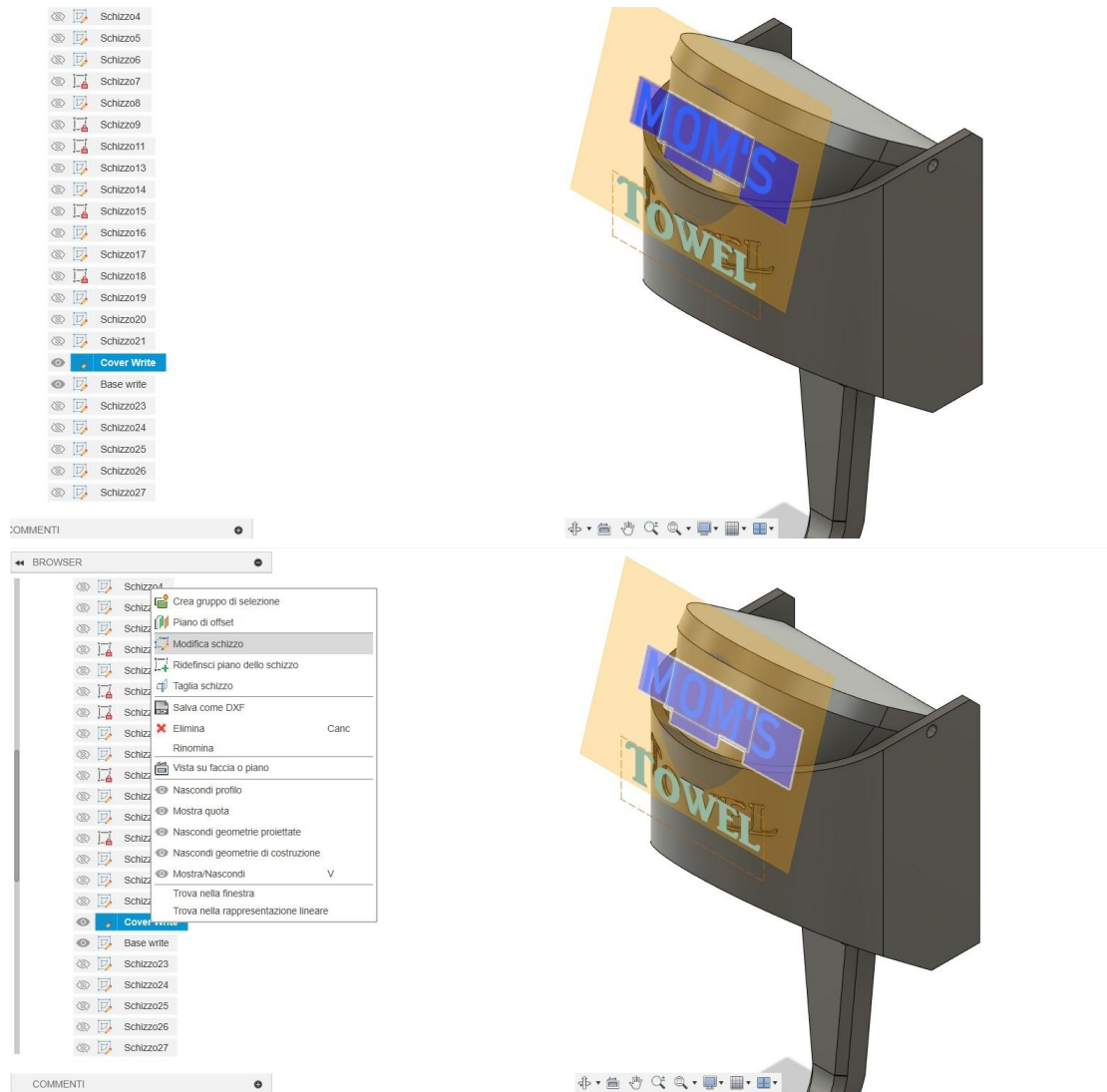

Click 2 times on the writing to be modified until it turns blue and modify it using the drop-down menu on the right.

Press ok to confirm.

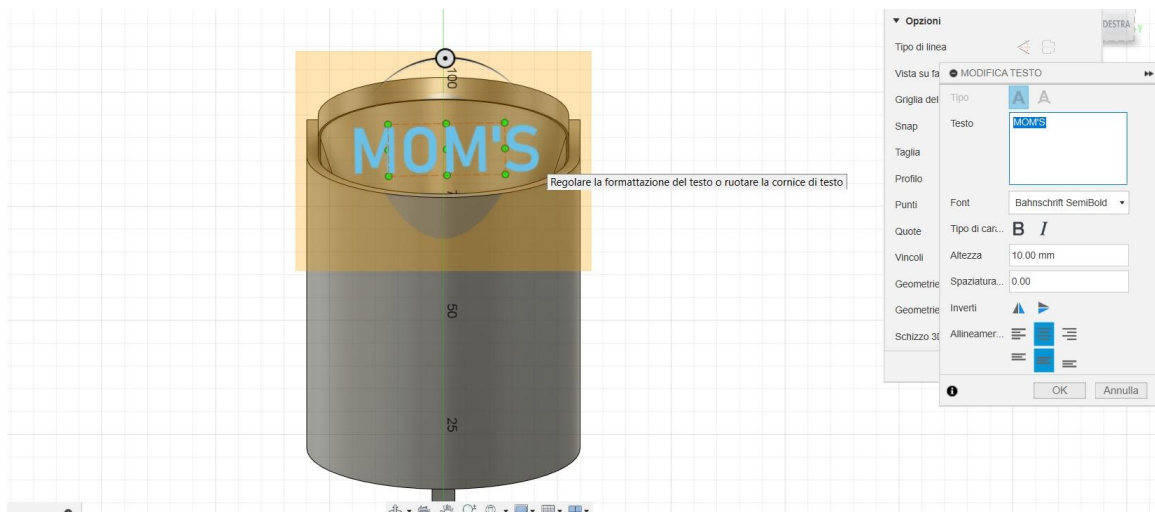

From the fusion menu select “Emboss”.

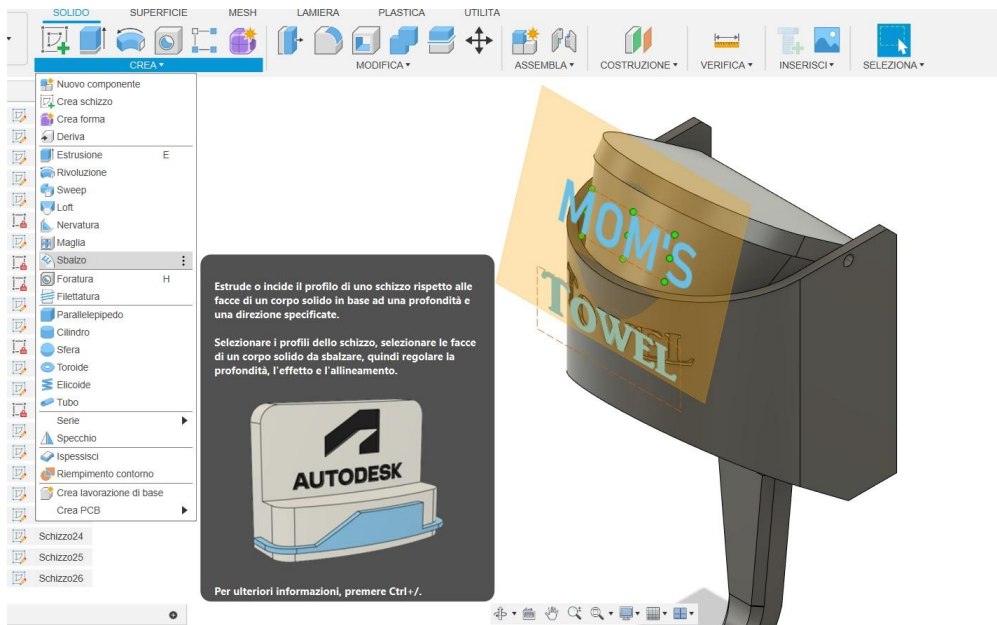

First select the writing to be extruded and then the face where it will be imprinted.

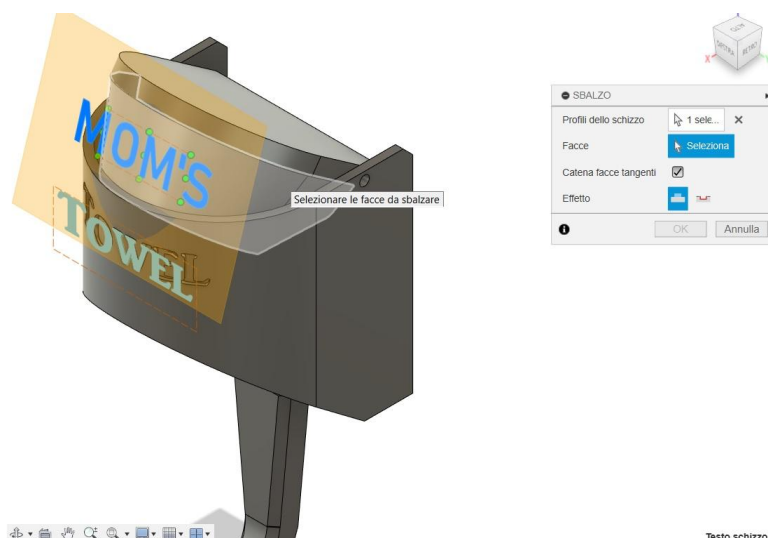

Cut the surface to be imprinted by entering the value -1 mm and press ok.

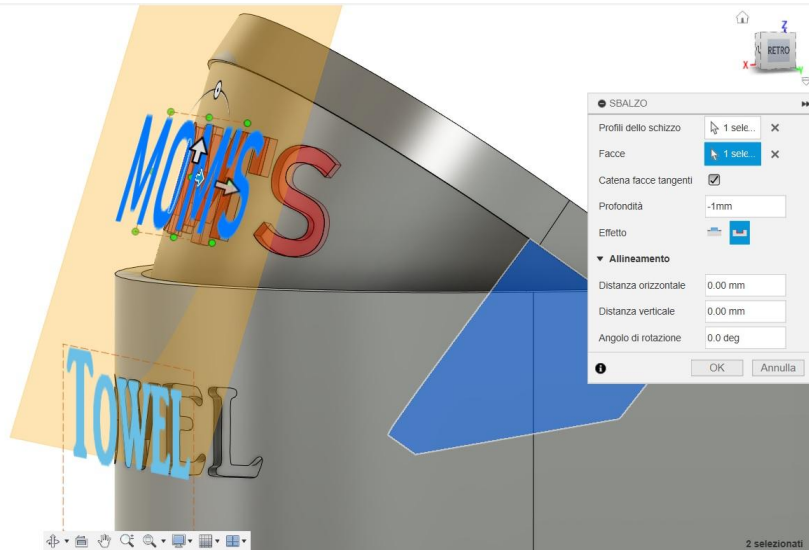

You are ready to export the stl file and print it!

Model files

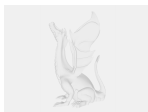

towel-hook.f3d



wall-holder.stl



base.stl



hookrod.stl



cover.stl

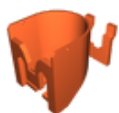

base-and-wall-holder.3mf



cover-and-hook.3mf

Print files

cover-and-hook_06n_02mm_pla_mk3s_1h39m.gcode



PLA 0.60 mm 0.20 mm 1.64 hrs 26 g Prusa MK3/S/S+

base-and-wall-holder_06n_03mm_pla_mk3s_2h5m.gcode



PLA 0.60 mm 0.30 mm 2.08 hrs 45 g Prusa MK3/S/S+

License ©

This work is licensed under a
[Creative Commons \(4.0 International License\)](#)



Attribution—Noncommercial—Share Alike

- ✗ | Sharing without ATTRIBUTION
- ✓ | Remix Culture allowed
- ✗ | Commercial Use
- ✗ | Free Cultural Works
- ✗ | Meets Open Definition