

Toolhead for Eryone Thinker E3D v5 CFD (Anycubic Mega or Chiron hotend) and 5015 fan

 Yurii

[VIEW IN BROWSER](#)

updated 6. 1. 2024 | published 6. 1. 2024

Summary

Toolhead for Eryone Thinker E3D v5 CFD (Anycubic Mega or Chiron hotend) and 5015 fan

[3D Printers](#) > [Other Printer Parts & Upgrades](#)

Tags: [e3d](#) [hotend](#) [mega](#) [anycubic](#) [e3dhotend](#) [chiron](#) [5015](#) [anycubici3mega](#) [e3dv5](#) [i3mega](#) [toolhead](#) [eryone](#) [eryonethinker](#)

This remix is based on

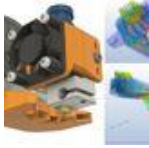

E3D v6 CFD optimized adjustable part cooling duct

by DaVinci2000

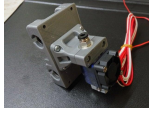

Anet A8 E3D V6 mount

by Jeka_tm

Model files



1.stl

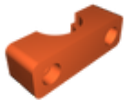

2.stl



3.stl



4.stl



5.stl

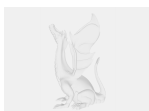

toolhead-for-eryone-thinker-e3d-v5.step

License

This work is licensed under a
Creative Commons (4.0 International License)



Attribution—Noncommercial—Share Alike

- ✗ | Sharing without ATTRIBUTION
- ✓ | Remix Culture allowed
- ✗ | Commercial Use
- ✗ | Free Cultural Works
- ✗ | Meets Open Definition