



Toothbrush support (with add-ons)



Alexandru Capatina

[VIEW IN BROWSER](#)

updated 6. 1. 2024 | published 6. 1. 2024

Summary

Philips Sonicare support with different options: standalone, with toothpaste, double wall support or with invisalign kit

[Household](#) > [Bathroom](#)

Tags: [shelf](#) [wallmount](#) [bathroom](#) [toothbrush](#) [toothpaste](#)
[wallmounted](#) [shelves](#) [philips](#) [sonicare](#) [invisalign](#)

I made a Philips Sonicare support with different options: standalone, with toothpaste, double wall support or with invisalign kit.

I added the invisalign kit just because I am currently using it and thought it might come in handy for someone else.

There are 3 options for the wall base: single with tape, single with screws or double with tape + screws (for better fit). I chose the double one and hid the screw holes behind my mirror.

The slide system can be used for anything else really, you just need to respect the dimensions for the base and the inserts in the rails.

I added some photos with the dimensions as well for anyone who wants to design their own shelves.

Model files

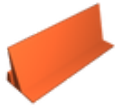

wall_base_tape.stl



wall_base_screw.stl

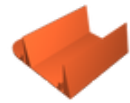

wall_base_double.stl



philipspaste_support.stl



philips_support.stl



invisalign_suport.stl

License

This work is licensed under a
[Creative Commons \(4.0 International License\)](https://creativecommons.org/licenses/by/4.0/)



Attribution

- ✗ | Sharing without ATTRIBUTION
- ✓ | Remix Culture allowed
- ✓ | Commercial Use

- ✓ | Free Cultural Works
- ✓ | Meets Open Definition