



PS4 Camera tripod adapter



Bob

[VIEW IN BROWSER](#)

updated 6. 1. 2024 | published 6. 1. 2024

Summary

I wanted to be able to mount my PS4 (VR) camera to a standard(us) camera mount.

[Gadgets](#) > [Video Games](#)

Tags: [camera](#) [mount](#) [playstation](#) [tripod](#) [adapter](#) [shoe](#)
[vr](#)

I don't know why there isn't threads on the mount to fit a standard tripod mount. I designed this real quick to allow me to mount my PS4 camera to a standard boom arm fitting.

I printed in PETG but it should be fine in PLA. Use 4-5 walls as the hole is not threaded. As long as you use a metal screw, it should bite right into the plastic. You may be able to use heat inserts as well, but I haven't tested it.

I printed it flat, because i always have trouble with holes on the side, but you may be able to save on some support material if you print it sideways.

Model files

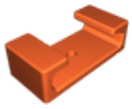

ps-cam-v1.stl

License ©

This work is licensed under a
[Creative Commons \(International License\)](#)



Public Domain

-
- ✓ | Sharing without ATTRIBUTION
 - ✓ | Remix Culture allowed
 - ✓ | Commercial Use
 - ✓ | Free Cultural Works
 - ✓ | Meets Open Definition