

3D MODEL ONLY

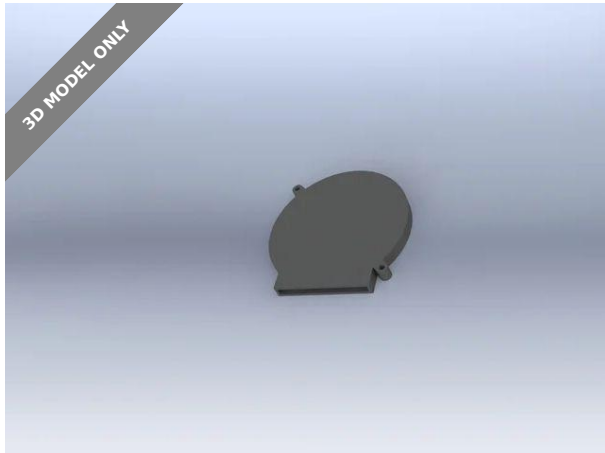

CREALITY K1 MAX SIDE FAN MOD

**Firefly**[VIEW IN BROWSER](#)

updated 6. 1. 2024 | published 6. 1. 2024

Summary

A lid for the side fan for Creality K1 Max model.

[3D Printers](#) > [Creality Parts & Upgrades](#)

Tags: [creality](#) [k1](#) [k1max](#)

A lid for the side fan for Creality K1 Max model.
Taking air from underneath instead and making the fan more silent.
It is possible to mount a filter inside the mod but be careful not to restrict too much airflow.

Mounted by 2 self tapping screws m4,8 x 25mm

Have a kick ass day!

//Firefly

Model files



k1maxsidefancoverv2.stl

License ©

This work is licensed under a
[Creative Commons \(International License\)](#)



Public Domain

-
- ✓ | Sharing without ATTRIBUTION
 - ✓ | Remix Culture allowed
 - ✓ | Commercial Use
 - ✓ | Free Cultural Works
 - ✓ | Meets Open Definition