



Lock-On Light Chain Pull



Gambit3le

[VIEW IN BROWSER](#)

updated 7. 1. 2024 | published 7. 1. 2024

Summary

Chain Pull with push-in lock.

[Household](#) > [Other House Equipment](#)

Tags: [chain](#) [pull](#) [3mm](#) [locking](#)

I wanted a bigger chain pull for my lamp.

I made this with a push in clip that locks it to the chain. Note: It's pretty much a one-time-use thing, so make sure you test fit it lightly before putting it together. May require a bit of light sanding to get everything to fit. Make sure NOT to use a Brim or any supports.

Do use the highest quality settings your printer will handle For mine that was .12mm layers.

It only takes about ten minutes to print.

Note, This works only with 3mm pull chains.

To assemble. Push the chain down through the top hole until it is almost coming out of the bottom. Then slide the lock in place and push until it bottoms out. Use some force to get it in there, I pushed on it with the edge of a pair of pliers.

That's it.

Enjoy!

Model files



chain-pull-chain-pull-body-v2.stl

☐ Should print fine without supports.

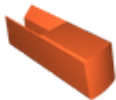

chain-pull-chain-pull-clip-v2.stl

License

This work is licensed under a
[Creative Commons \(4.0 International License\)](https://creativecommons.org/licenses/by-nc-nd/4.0/)



Attribution—Noncommercial—No Derivatives

- ✖ | Sharing without ATTRIBUTION
- ✖ | Remix Culture allowed
- ✖ | Commercial Use
- ✖ | Free Cultural Works
- ✖ | Meets Open Definition