



MiniZ Ford Mustang 1967/68 fastback with more wheel clearance



CoolDoctorJ

[VIEW IN BROWSER](#)

updated 8. 1. 2024 | published 8. 1. 2024

Summary

1968 Ford Mustang body for 1:28 scale RC cars with a 90mm wheel base. This version has additional wheel clearance.

[Hobby & Makers](#) > [RC & Robotics](#)

Tags: [rc](#) [rccar](#) [miniz](#) [rccarparts](#)

This is a remix of the [MiniZ Ford mustang 1967/68 fastback \(sportroof\) body](#). I cut out additional clearance for the front and rear wheels in order to allow better steering and suspension travel specifically on the [Fully Printed 1:28 Car Chassis \(MINI-Z compatible\)](#). It should theoretically also be compatible with a normal Mini-Z chassis with a 90mm wheel base.

I also remixed the screw holes on the front clip for more durability, as I was finding that they would break at the slightest crash. It should still accommodate M2 screws in the same position as the wider holes in the original clip.

I have also included a body with even more wheel clearance, at the cost of looking a little silly and some slightly lowered detail on the overall model.

This remix is based on



MiniZ Ford mustang 1967/68 fastback (sportroof) body
by Blunte

Model files



mustang-body-90mm-extra-wheel-clearance.stl

☐ Highest detail version.

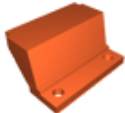

beefier-front-clip-for-mustang-body.stl

☐ Should result in less breakage when crashing.



mustang-body-extra-widened-wheel-wells.stl

☐ Even more wheel clearance, but the overall model detail has been reduced.

License

This work is licensed under a
Creative Commons (4.0 International License)



Attribution-NonCommercial

- ✗ | Sharing without ATTRIBUTION
- ✓ | Remix Culture allowed
- ✗ | Commercial Use
- ✗ | Free Cultural Works
- ✗ | Meets Open Definition

