



## Chess board with storage compartment



byWulf

[VIEW IN BROWSER](#)

updated 23. 2. 2024 | published 23. 2. 2024

## Summary

Multi color print with no supports needed

[Toys & Games](#) > [Board Games](#)

Tags: [boardgames](#) [boardgame](#) [chessboard](#) [checkers](#) [checkersboard](#) [dame](#) [damespiel](#) [schach](#) [schachbrett](#) [laska](#) [baschni](#)

This chess board is printed in four pieces with some extra connecting pieces and has 4x4 cm fields for the figure pieces.

It can be folded to provide a compartment for the figures and to be stored easily. When unfolded, it lays plain on the table without wobbling.

### What you need:

- Printer capable of multi color prints and a print bed of at least 170x170mm
- About 460g black and 63g white filament (PLA+ suggested)
- 6x screws M3\*30
- 4x screws M3\*12
- 10x nuts M3

- Chess figures (there are many models here on printables)

### How to print:

- Depending on your slicer, you can just use the fill bucket to change the color of the squares on the under side. Always start in the same corner, so the patterns match at the end. Test it by placing all 4 box parts together in your slicer and check the color of your squares!
- Print each of the four box models once. Print the latch two times. Print the hinge four times.

### How to assemble:

- Connect box 1 and 2 with the small screws.
- Connect box 3 and 4 with the small screws.
- Connect these two halves with the hinges and the long screws (see the second image)
- Add the latches with another set of long screws (see the fourth image)
- Carefully close the box and try to close the latch. It can be really hard at the beginning. If so, take a knife and remove a little bit of material from the box where the latch touches until it is easy to open and close.

## Model files

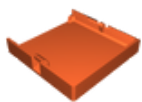

**box\_1.stl**

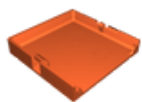

**box\_2.stl**



**box\_3.stl**

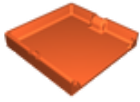

**box\_4.stl**



**latch.stl**

☐ Two needed. Print with strength settings

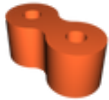

**hinge.stl**

☐ Four needed. Print with strength settings

## License



This work is licensed under a  
[Creative Commons \(4.0 International License\)](https://creativecommons.org/licenses/by-sa/4.0/)

**Attribution-ShareAlike**

- ✗ | Sharing without ATTRIBUTION
- ✓ | Remix Culture allowed
- ✓ | Commercial Use
- ✓ | Free Cultural Works
- ✓ | Meets Open Definition