



# Magnetic Coupler



Hatsuseno Rin

[VIEW IN BROWSER](#)

updated 8. 1. 2024 | published 8. 1. 2024

## Summary

A strong magnetic coupler

[Household](#) > [Other House Equipment](#)

Tags: [magnet](#) [detachable](#) [coupler](#) [attachment](#) [removable](#)

A magnetic coupler housing designed for strong magnets (19.2 x 9.1 x 4.5mm). I saw many such couplers but none of them is strong enough for my need.

This design uses gummy double-sided tapes inside to fix the strong magnet in place (top, bottom and back). It provides a bit of cushioning for frequent impacts. I used ~0.5mm thick tapes which worked very well. You can also use soft glue if preferred.

**Important:** make sure the 2 magnets **attract each other** before fixing them in the housing! 😊

# Model files

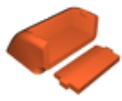

## magnet-housing.stl

☐ no screw holes

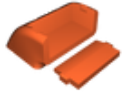

## magnet-housing-screws.stl

☐ with 2.5mm screw holes

# License

This work is licensed under a  
[Creative Commons \(4.0 International License\)](https://creativecommons.org/licenses/by-nc/4.0/)



**Attribution-NonCommercial**

- ✗ | Sharing without ATTRIBUTION
- ✓ | Remix Culture allowed
- ✗ | Commercial Use
- ✗ | Free Cultural Works
- ✗ | Meets Open Definition