



IKEA Stubbarp Leg Extension For Bestå or Sofa



Vision Forge Creations

[VIEW IN BROWSER](#)

updated 7. 1. 2024 | published 7. 1. 2024

Summary

A 10mm distance plate fits between sofa and legs, letting my robot vacuum effortlessly pass through.

[Household](#) > [Living Room](#)

Tags: [leg](#) [ikea](#) [robot](#) [legs](#) [ikeahack](#) [vacuum](#) [distance](#) [extension](#) [sofa](#) [besta](#) [roborock](#) [vacuumrobot](#) [stubbarp](#)

A 10mm distance plate, designed to be inserted between the legs of your furniture.

This allows for ample clearance, enabling my robot vacuum to effortlessly navigate underneath the entire sofa.

Technical details:

- Height between leg and attachment: 10mm
- Total height: 15mm
- Outer dimensions: 49x49mm
- Inner dimensions: 45x45mm
- Hole for existing screw: Ø12mm

Printing orientation:

Refer to the image.

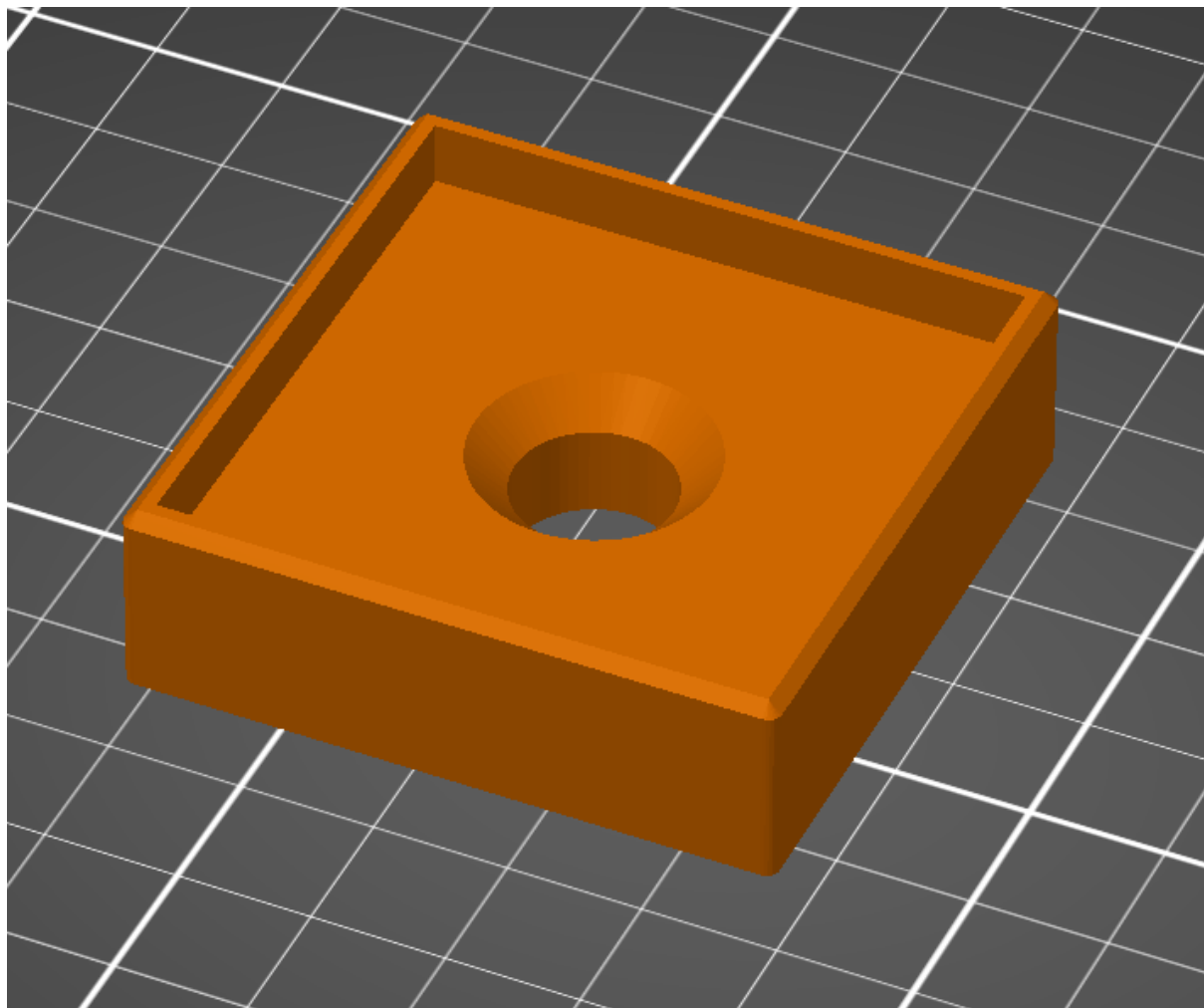

Model files

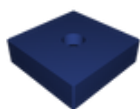

ikea-stubbarp-leg-extension-v4.3mf

License ©

This work is licensed under a
[Creative Commons \(4.0 International License\)](https://creativecommons.org/licenses/by-nc-sa/4.0/)



Attribution—Noncommercial—Share Alike

- ✗ | Sharing without ATTRIBUTION
- ✓ | Remix Culture allowed
- ✗ | Commercial Use
- ✗ | Free Cultural Works
- ✗ | Meets Open Definition