



Drawer 'woven' Hexagon basket for IKEA NYSJÖN high cabinet



KatFret

[VIEW IN BROWSER](#)

updated 14. 1. 2024 | published 14. 1. 2024

Summary

Drawer basket with a hexagon / honeycomb decoration for the IKEA NYSJÖN high cabinet. Ideal for bathroom organization.

[Household](#) > [Bathroom](#)

Tags: [hexagon](#) [organizer](#) [ikea](#) [bathroom](#) [honeycomb](#)
[organization](#) [basket](#) [drawer](#) [woven](#) [nysjon](#)

Model

This is a drawer and/or basket with a honeycomb decoration for the IKEA NYSJÖN high cabinet. Ideal for bathroom organization such as those pesky loose towels, deodorant cans, cotton wipes, tubes of toothpaste, dental floss.. You name it!

It's a fairly straightforward build, you'll only need some (super)glue besides the printed parts. Detailed instructions can be found below.

Note: The basket halves fit perfectly on a Bambu Lab P1 and X1 buildplate. For other buildplate volumes use the quartered variant of the basket.

Enjoy! Please like the model if you did, it's much appreciated! I'd love to see any makes if you printed one :)

Update: Added a quartered variant of the drawer basket for those with smaller buildplates. Includes additional drawer connector parts to glue to the inside of the top rim.

Instructions

1. Choose the necessary parts which best fit your build plate, printing in parts is supported with the connector pieces and (super)glue. Areas to glue are indicated in the steps below.
2. The guide rails, pressfit connectors and connectors all are symmetric and can be used on both the left and right sides of the cabinet. The front and back connector are only needed if you're using the 4 part drawer basket variant.
3. The side panel connectors and drawer stop pins have multiple tolerance versions, pick the one which best suits your printer.
4. Print 2 of each guide rail, drawer connector, drawer stop pin.
Print 4 of the drawer to side panel connectors.
Pick the drawer part sizes which suit your build plate:
A: Drawer in 2 halves: Print 1 front and back. You can choose to go for a solid base or a woven honeycomb base.
B: Drawer in 4 quarters: Print quarter parts 1 thorough 4. You can again choose to go for a solid base or a woven honeycomb base.
5. If you printed the guide rails in parts, start with glueing the guide rails together using the guide rail connector, see the result below, top rail is glued from 3 parts, bottom rail is a single 3D print.

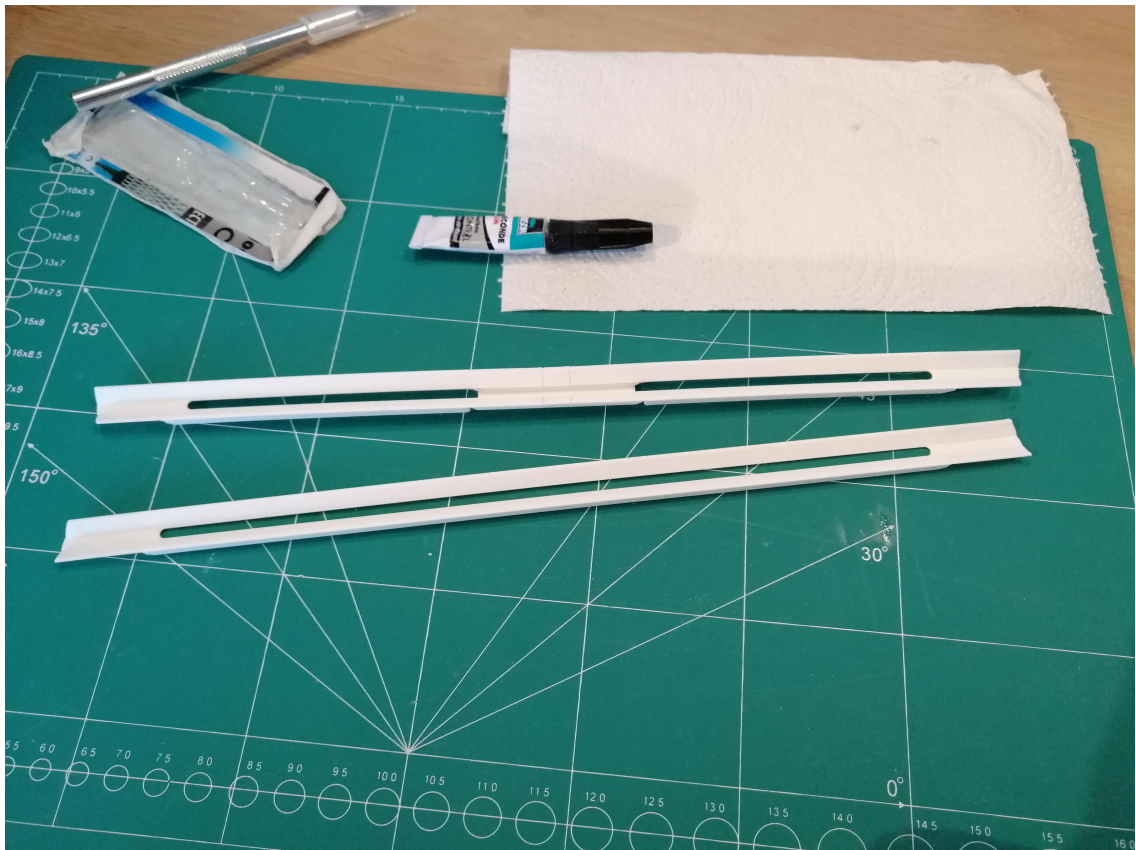

6. Next, glue the back side of the guide rail to one of the 'drawer to panel connectors', see step below. Repeat this for the other side. Note the curvature of the rail piece should match that of the connector.

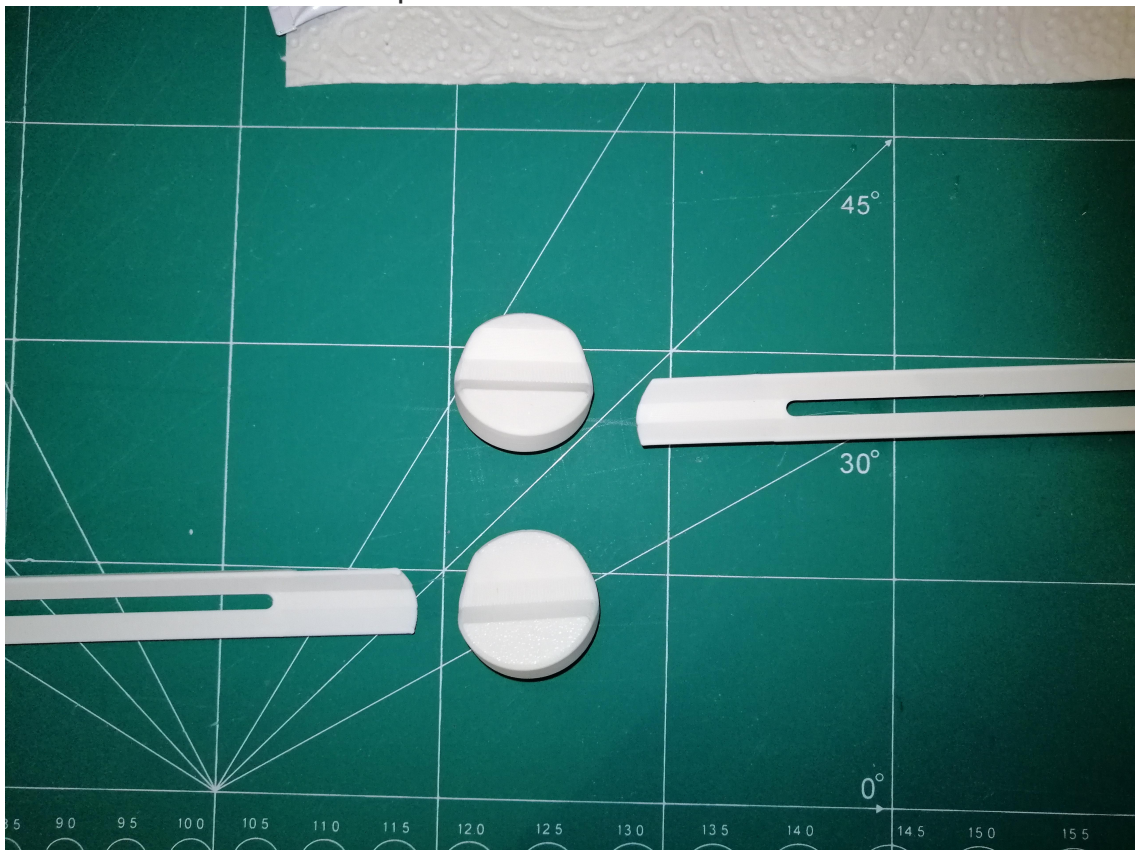

7. Press fit the single connector with rail in the back of the cabinet. Press fit a second connector in the front and glue the rail to the front

connector ensuring a good fit. Note: Gluing in place should prevent misalignment issues between the pins and the side panels of the cabinet.



8. Repeat the above step for the other side. You should now have two side rail guide assemblies ready to receive the basket. So let's make that basket!
9. Use the dovetails to align the basket parts. Use glue on edge face and on the diagonal face of the dovetail joint.
10. Grab the drawer connectors and glue to the inside of the basket rail on the left and right to connect the basket front and back, increasing structural strength.

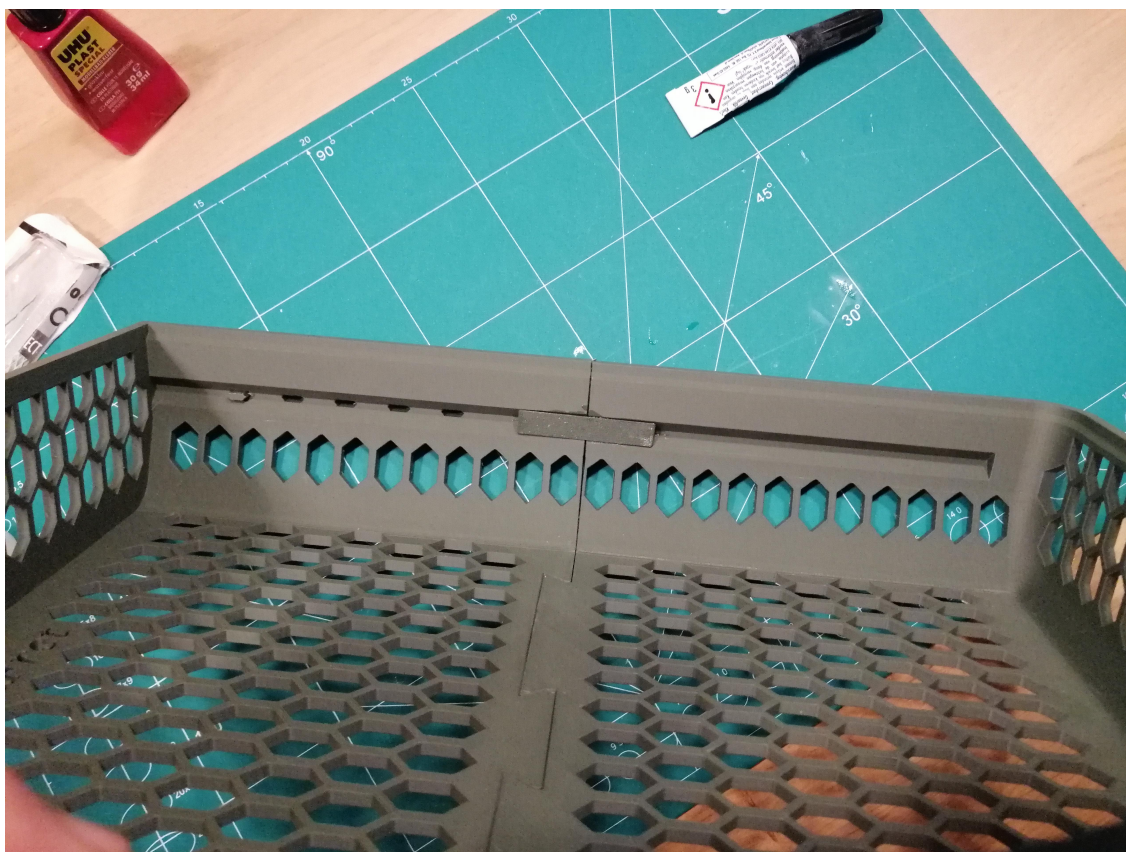

Note, if you're using the quartered variant, also glue to front and back drawer connectors to the inside of the drawer at the top, see images below.

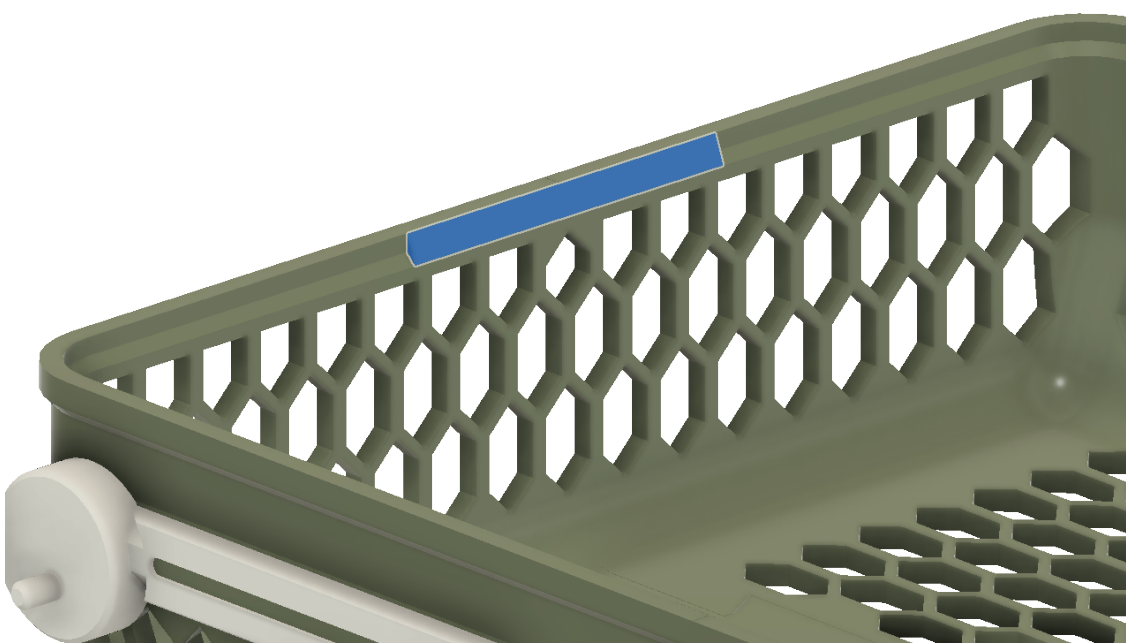

11. Insert the drawer partially into the rails inside the cabinet and press fit the drawer stop pin on both sides to your desired stop position.

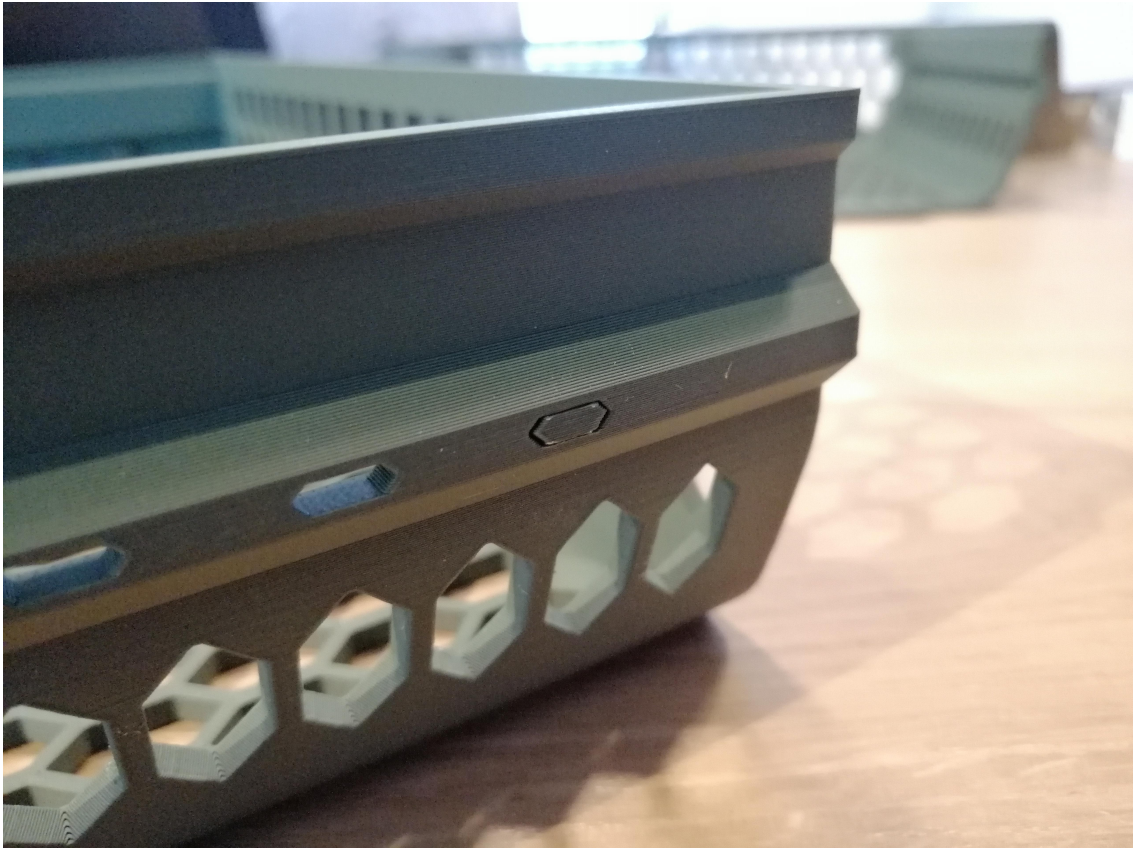

12. Try out the drawer, organize your bathroom and enjoy! I'd love to see any makes or hear your experiences.

If anything is unclear, don't hesitate to ask, I'd be happy to help.

Dimensions

Internal:

- Length 329 mm
- Width: 237 mm
- Height: 66 mm

External including rails:

- Length: 337 mm
- Width: 268 mm
- Height: 70 mm

Tips and tricks

- **No support** needed
- Use the supplied custom brim models for easy clean-up if bed adhesion is an issue when printing the rail guides.
- Test printed with 0.4mm nozzle

- Test printed with 0.2mm layer height
- Try out the different tolerance versions to see what works best for your printer.
- If the drawer doesn't slide smooth enough, try grease or tea light / candle wax on the sliding surfaces.

Model files

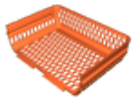

drawer-basket-woven-base-halved-dovetail-part-2-fro... .stl

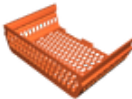

drawer-basket-woven-base-halved-dovetail-part-1-back .stl



drawer-basket-solid-base-halved-dovetail-part-2-fro... .stl

☐ Solid base version

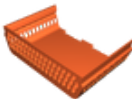

drawer-basket-solid-base-halved-dovetail-part-1-back .stl



drawer-to-panel-connector-pressfit-48.stl

☐ Side panel connector. 0.2mm tolerance to 5mm hole



drawer-to-panel-connector-pressfit-49.stl

☐ Side panel connector. 0.1mm tolerance to 5mm hole



drawer-to-panel-connector-pressfit-50.stl

☐ Side panel connector. No tolerance to 5mm hole



guide-rail-full-length.stl



guide-rail-2-parts-part-1.stl



guide-rail-2-parts-part-2.stl



guide-rail-2-parts-custom-brim-part-1.stl

☐ Use this model for better bed adhesion and easy cleaning



guide-rail-2-parts-custum-brim-part-2.stl

☐ Use this model for better bed adhesion and easy cleaning

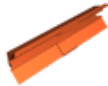

connector-for-2-part-guide-rail.stl

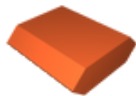

stop-pin-01.stl

☐ Drawer end stop pin with a tolerance of 0.1mm

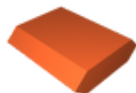

stop-pin-03.stl

☐ Drawer end stop pin with a tolerance of 0.2mm



stop-pin-02.stl

☐ Drawer end stop pin with a tolerance of 0.3mm



drawer-connector-sides.stl

☐ Print 2 and glue to the inside of the basket rail to connect the basket front and back



drawer-basket-solid-base-quarter-dovetail-part-1-fr... .stl

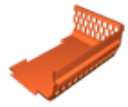

drawer-basket-solid-base-quarter-dovetail-part-2-fr... .stl



drawer-basket-solid-base-quarter-dovetail-part-3-ba... .stl

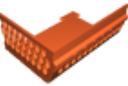

drawer-basket-solid-base-quarter-dovetail-part-4-ba... .stl



drawer-basket-woven-base-quarter-dovetail-part-1-fr... .stl

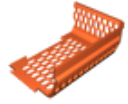

drawer-basket-woven-base-quarter-dovetail-part-2-fr... .stl



drawer-basket-woven-base-quarter-dovetail-part-3-ba... .stl

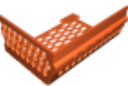

drawer-basket-woven-base-quarter-dovetail-part-4-ba... .stl



drawer-connector-front.stl

☐ For quarter drawer, print 1 and glue to the inside front.



drawer-connector-back.stl

☐ For quarter drawer, print 1 and glue to the inside back.

License

This work is licensed under a
Creative Commons (4.0 International License)



Attribution-NonCommercial

- ✗ | Sharing without ATTRIBUTION
- ✓ | Remix Culture allowed
- ✗ | Commercial Use
- ✗ | Free Cultural Works
- ✗ | Meets Open Definition