



Glass/Mirror clip



Patrik Kokinda

[VIEW IN BROWSER](#)

updated 7. 1. 2024 | published 7. 1. 2024

Summary

Clip for holding glass or mirror in place in cabinet

[Household](#) > [Other House Equipment](#)

Tags: [clip](#) [glass](#) [mirrorholder](#) [mirror](#) [glassholder](#)

This is a very simple model for a clip that holds glass or mirrors in place in cabinets or wardrobes. With a recess hole for the screw.

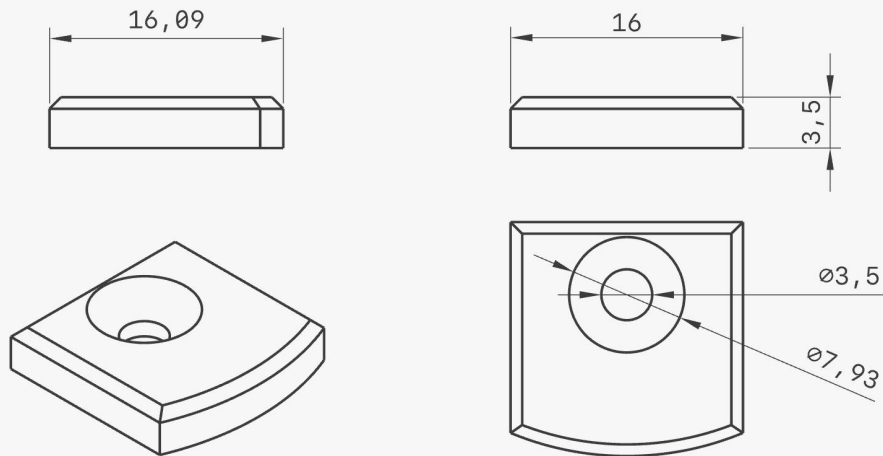

I have uploaded a single model, so you can print either one that you lost or as many as you want.

Obviously, no supports are needed; just lay flat with 10-15% infill.
 Best printed in PETG for strength, but PLA tested and works just fine.
 For extra points, I recommend turning on **ironing** for a smoother top layer and much better and smoother looks of the clip:

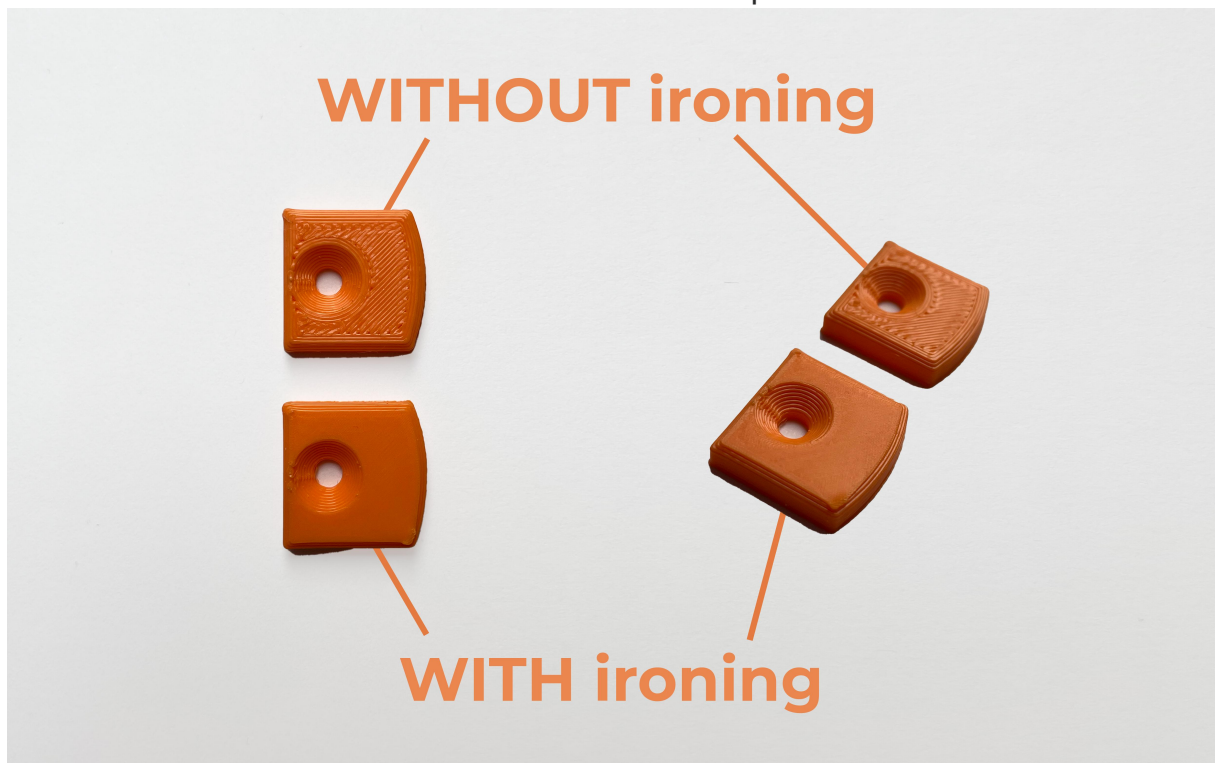

Model files

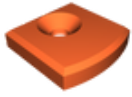

mirrorglass_clip.3mf

License

This work is licensed under a
[Creative Commons \(4.0 International License\)](#)



Attribution-NonCommercial

-
- ✗ | Sharing without ATTRIBUTION
 - ✓ | Remix Culture allowed
 - ✗ | Commercial Use
 - ✗ | Free Cultural Works
 - ✗ | Meets Open Definition