

## T-style garage door bottom seal overhead door

 **mierwins**

[VIEW IN BROWSER](#)

updated 7. 1. 2024 | published 7. 1. 2024

### Summary

T-End Garage Door seal to use on shortened ends. Overhead door bottom seal for dual channel doors.

[Household](#) > [Garage](#)

Tags: [door](#) [seal](#) [garage](#)

T-end Garage Door seal. Created to solve the problem of ends shrinking over time and allowing rodents in. Take this and enlarge or reduce to your needed length. The inner tube slides into the existing tube to hold it in place. I recommend rubber cement before you join them to hold it securely.

### Model files

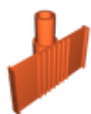

**t-end-garage-door-seal.stl**

# License ©

This work is licensed under a  
**Creative Commons (4.0 International License)**



**Attribution—Noncommercial—No Derivatives**

---

- ✗ | Sharing without ATTRIBUTION
- ✗ | Remix Culture allowed
- ✗ | Commercial Use
- ✗ | Free Cultural Works
- ✗ | Meets Open Definition