

Paper Towel Bracket



s31ryuu

[VIEW IN BROWSER](#)

updated 7. 1. 2024 | published 7. 1. 2024

Summary

Bracket to hang paper towel rolls to a shelf

[Household](#) > [Garage](#)

Tags: [shelf](#) [bracket](#) [papertowel](#)

I printed it in PLA+ and it is really sturdy. The pin is to lock the tube when a roll of paper towel is installed. When you need to change roll you remove the pin and slide out the tube.

The tube is made in two pieces so it can be printed with an ender 3 style printer and then glued together.

Model files

bracket.stl

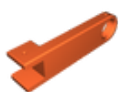

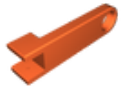

bracketmirror.stl

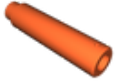

tube1.stl

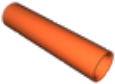

tube2.stl



pin.stl

License

This work is licensed under a
[Creative Commons \(4.0 International License\)](#)



Attribution-NonCommercial

- ✗ | Sharing without ATTRIBUTION
- ✓ | Remix Culture allowed
- ✗ | Commercial Use
- ✗ | Free Cultural Works
- ✗ | Meets Open Definition