

Anycubic Kobra X axis cover



Mikagu

[VIEW IN BROWSER](#)

updated 13. 1. 2024 | published 13. 1. 2024

Summary

Anycubic Kobra X axis cover replacement.

[3D Printers](#) > [Anycubic Parts & Upgrades](#)

Tags: [replacement](#) [anycubic](#) [kobra](#) [anycubickobra](#)
[xaxiscover](#)

Anycubic Kobra X axis cover replacement. I've added a guide for cables as I designed this part to be used with an Arduino PIR Sensor for the “[Universal 3D Printer Automatic Shutdown System](#)” project I made.

Arduino PIR Sensor case: [LINK](#)

Model files

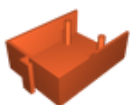

[anycubic-kobra-x-axis-cover.stl](#)

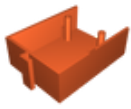

anycubic-kobra-x-axis-cover.stl

License ©

This work is licensed under a
[Creative Commons \(4.0 International License\)](#)



Attribution-NonCommercial

- ✗ | Sharing without ATTRIBUTION
- ✓ | Remix Culture allowed
- ✗ | Commercial Use
- ✗ | Free Cultural Works
- ✗ | Meets Open Definition