

Stylish Wall Lamp

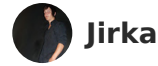

Jirka

[VIEW IN BROWSER](#)

updated 10. 1. 2024 | published 10. 1. 2024

Summary

Stylish easy to print wall lamp.

[Household](#) > [Bedroom](#)

Tags: [wall](#) [light](#) [lamp](#) [led](#) [wallmount](#) [bed](#) [bedroom](#)

3D printed Wall mounted lamp.

I plan to model more of the top mounts so everybody can have what he/she/it likes.

This model uses E27 socket with switch and plug: https://www.amazon.de/-/cs/gp/product/B0967G5RHR/ref=ppx_yo_dt_b_asin_image_o00_s01?ie=UTF8&th=1

+ E27 light source. Just have in mind that the body is plastic, so choose one that produce as less heat as possible. In my case i used these: https://www.amazon.de/-/en/gp/product/B0BNNC2S75/ref=ppx_yo_dt_b_asin_image_o00_s00?ie=UTF8&psc=1

And 2 screws for attaching to wall.

Printing:

- For the bottom cover use at least 3 walls because the 2 rods holds the whole light together.
- When slicing, stick to the foto in galery.

Assembly + installation:

- You can **optionaly** print the **template** to help find holes to drill.
1. Assembling beggins by putting and screwing the **E27 light socket** inside of the **mount** + route the cable into the mount hole at the bottom.
 2. Close the bottom of the mount with **bottom cover** by aligning the 2 rods into the 2 holes of the **mount**, also when closing you will seal the cable hole so make sure the cable will not be damaged.
 3. Attach the **Top cover** part to the top of the **mount**, again align 2 holes of the **top cover** with the 2 rods.
 4. Screw the 2 nuts onto the rods so all the parts sticks together. You can optionaly print the key which helps with screwing.
 5. Now you can install the **E27 light source**
 6. Screw the light on the desired place on the wall. You can either preinstal 2 screws and then hang the light on them, or use angle wrench like this one: https://www.amazon.de/-/en/Multifunctional-Magnetic-Attachment-Adapter-Drilling/dp/B0C1P4CNQJ/ref=sr_1_3?keywords=right%2Bangle%2Bbit&qid=1704663596&sr=8-3&th=1

Plug the cable into the outlet and test the function.

Enjoy!

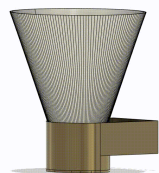

Model files



nut-print-two-of-these.stl



top-cover.stl



bottom-cover.stl

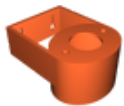

mount.stl



template.stl

License

This work is licensed under a
[Creative Commons \(4.0 International License\)](https://creativecommons.org/licenses/by-nc-sa/4.0/)



Attribution—Noncommercial—Share Alike

- ✗ | Sharing without ATTRIBUTION
- ✓ | Remix Culture allowed
- ✗ | Commercial Use
- ✗ | Free Cultural Works
- ✗ | Meets Open Definition

