



Basic Handle



IVA Shade

[VIEW IN BROWSER](#)

updated 7. 1. 2024 | published 7. 1. 2024

Summary

This handle is mainly designed to protect your hand when carrying 5-10L water bottles. Use "Fuzzy Skin" for texture.



3.50 hrs



1 pcs



0.20 mm



0.40 mm



Flex



29 g



Ender 3 S1

[Gadgets](#) > [Other Gadgets](#)

Tags: [handle](#) [carrying](#) [handles](#) [carry](#)

I tried lots of variations to increase the finger comfort. Then I realised its best to use plain cyclinder with textured surface like dumbbells. Enable the "Fuzzy skin" option before slicing to create the grippy surface. Also I recommend using brim to increase the adhesion.

I used TPU-95 with 4 walls and %40 infill so it became pretty tough.

It's my first ever 3d design. You may want to change something, so the step file is included.

Model files

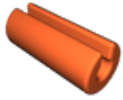

handle-prototype-wof-v1.stl

☐ Print with "Fuzzy Skin" option.



handle-prototype-wof-v1.step

Print files



ce3s1pro_handle-prorotype-wof-v1.gcode

 Flex  0.40 mm  0.20 mm  3.50 hrs  29 g

☐ Ender 3 S1 Pro at slow speed.

License ©

This work is licensed under a
[Creative Commons \(4.0 International License\)](#)



Attribution-ShareAlike

- ✗ | Sharing without ATTRIBUTION
- ✓ | Remix Culture allowed
- ✓ | Commercial Use
- ✓ | Free Cultural Works
- ✓ | Meets Open Definition