



Fender Mustang Pickup Switch Spacer



Hijinksensue

[VIEW IN BROWSER](#)

updated 15. 1. 2024 | published 15. 1. 2024

Summary

A simple model for lowering the pickup selector switches on a Fender Mustang so they don't scrape your knuckles.

[Hobby & Makers](#) > [Music](#)

Tags: [guitar](#) [fender](#) [pickup](#) [mustang](#)

I've included single and double switch models at 3.5mm and 4.5mm deep. The double configuration was sized for a 1994/95 MIJ MG65 Mustang. Not sure if the spacing will be correct for other models.

Model files



[mustang_pickguard_switch_spacer_double45mm.stl](#)

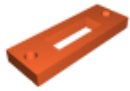

mustang_pickguard_switch_spacer_single_45mm.stl



mustang_pickguard_switch_spacer_single_35mm.stl



mustang_pickguard_switch_spacer_double_35mm.stl

License ©



This work is licensed under a
[Creative Commons \(4.0 International License\)](#)

Attribution-NonCommercial

- ✗ | Sharing without ATTRIBUTION
- ✓ | Remix Culture allowed
- ✗ | Commercial Use
- ✗ | Free Cultural Works
- ✗ | Meets Open Definition