



## Marvel Remix remixed - simple insert with card holder



[VIEW IN BROWSER](#)

updated 21. 1. 2024 | published 21. 1. 2024

### Summary

Marvel Remix remixed - simple insert with 2 card trays and a card holder

[Toys & Games](#) > [Board Games](#)

Tags: [holder](#) [card](#) [marvel](#) [game](#) [board](#) [insert](#)

Hi guys,

this is a simple insert for the game Marvel: Remix.

<https://boardgamegeek.com/boardgame/359152/marvel-remix>

The insert consists of 2 card trays (one for Remix and one for Villian cards) and one card holder. The card holder is used as a filler in the box but can also hold the cards in the common discard pile during the game. Suggestions for better stability are welcome.

I initially printed 2 trays which are looser in the box but firmer for the cards and vice versa. Providing both versions.

Tested with 80 micron sleeves.

If anyone wishes to improve this design or suggest improvements etc., it is highly welcome.

## This remix is based on



### Fort Insert

by Mišák

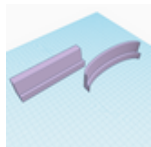

### Game card holder

by tinkerman214

## Model files



**marvel\_remix\_card-stand.stl**



**marvel\_remix\_card\_tray\_firmer.stl**

☐ Please print 2 of these or the 2 of the looser trays :)



**marvel\_remix\_card\_tray\_looser.stl**

☐ Please print 2 of these or 2 of the former trays :)

## License

This work is licensed under a  
[Creative Commons \(4.0 International License\)](https://creativecommons.org/licenses/by-nc-sa/4.0/)



## Attribution—Noncommercial—Share Alike

---

- ✗ | Sharing without ATTRIBUTION
- ✓ | Remix Culture allowed
- ✗ | Commercial Use
- ✗ | Free Cultural Works
- ✗ | Meets Open Definition