

## Modified Rookery V6-CHC Mount for clone v6 hot end

**T** Tomihawky

[VIEW IN BROWSER](#)

updated 15. 1. 2024 | published 15. 1. 2024

### Summary

Modified Rookery V6-CHC Mount for clone v6 hot end that sits 2mm higher so that the fan duct is properly aligned.

[3D Printers](#) > [Other Printer Parts & Upgrades](#)

Tags: [rook](#) [rookmk1](#) [rookery](#)

My clone V6 sat to low for the fan duct to work properly, so i raised it by 2mm in PrusaSlicer, the distance can be changed by adjusting the Y position of part4hotend as shown in the picture.

### This remix is based on

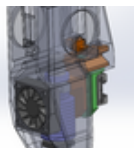

**Rookery V6-CHC Mount**  
by Gulsifer

# Model files



**rookery-v6-offset-mount.3mf**

☐ Import 3D models only

## License

This work is licensed under a  
**GNU**



**Lesser General Public License**

- 
- ✗ | Sharing without ATTRIBUTION
  - ✓ | Remix Culture allowed
  - ✓ | Commercial Use
  - ✓ | Meets Open Definition