



Magnetic japanese hand saw guide for square cuts

E Etil Vrye

VIEW IN BROWSER

updated 31. 7. 2021 | published 26. 7. 2021

Summary

This is a small jig to make square cuts using a japanese hand saw. No supports needed.



1.70 hrs



1 pcs



0.20 mm



0.40 mm



PLA



18 g



Prusa MINI /
MINI+

[Hobby & Makers](#) > [Tools](#)

Tags: [jig](#) [woodworking](#) [magnetic](#) [saw](#) [woodworkingtools](#)
[japanese](#) [handsaw](#)

This is a small jig to make square cuts using a japanese hand saw.

After printing you can just pop the magnets into the holes. I used 8x3 mm neodym magnets like these: <https://www.amazon.de/gp/product/B007KZGADE>. They give great support (but not to much) and the result is as square as it is possible with a hand-saw and without using a plane and shooting-board.

No supports are needed if you print it with guide-face down.

Model files



20210711-handsaw-guide-left-hand.stl

☐ For right handed people

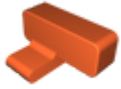

20210711-handsaw-guide-right-hand.stl

☐ For left handed people

Print files



20210711-handsaw-guide_02mm_pla_mini_1h42m.gcode

🌀 PLA 📏 0.40 mm ≡ 0.20 mm ⌚ 1.70 hrs ⚖️ 18 g 🖨️ Prusa MINI / MINI+

License ©



This work is licensed under a
[Creative Commons \(4.0 International License\)](https://creativecommons.org/licenses/by-nc-nd/4.0/)

Attribution—Noncommercial—No Derivatives

- ✗ | Sharing without ATTRIBUTION
- ✗ | Remix Culture allowed
- ✗ | Commercial Use
- ✗ | Free Cultural Works
- ✗ | Meets Open Definition