



## Inbus holder wall (up to 7mm)

 **Daydreamer**

[VIEW IN BROWSER](#)

updated 19. 1. 2024 | published 19. 1. 2024

### Summary

A simple inbus holder with a screwed wall mount. Perfectly for sports wich who are frequently in need of a inbus.

[Hobby & Makers](#) > [Tools](#)

Tags: [wall](#) [holder](#) [mount](#) [screw](#) [screwable](#) [inbus](#)

I've created a wall-mounted inbus holder designed for inbus keys up to 7mm in diameter. The rounded corners add a polished look, and the raised screw holes let you install it neatly, with the screw heads sitting flush. It's a practical and sleek solution for keeping your tools organized on the wall.

### Model files



**inbus-holder.stl**

inbus-holder-text.stl

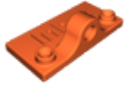

## License ©

This work is licensed under a  
[Creative Commons \(4.0 International License\)](#)



**Attribution-NonCommercial**

---

- ✗ | Sharing without ATTRIBUTION
- ✓ | Remix Culture allowed
- ✗ | Commercial Use
- ✗ | Free Cultural Works
- ✗ | Meets Open Definition