



Sledding snowman bobblehead



Astronaut3D

[VIEW IN BROWSER](#)

updated 29. 1. 2024 | published 29. 1. 2024

Summary

Your perfect companion during the winter.

[Seasonal designs](#) > [Winter & Christmas & New Year's](#)

Tags: [print](#) [snowman](#) [block](#) [bobblehead](#) [sled](#) [a](#) [blok](#)

This sledding snowman is a perfect print for the winter. Print all items at . 3mm layer height or less. Only the snowman needs supports the rest doesn't. To assemble insert the spring into the snowman, the snowman onto the sled, and the spring into the base.

More winter models coming December 2024!

If you enjoy this model, please consider

*Liking
Sharing
Posting a make*

Thank you

This remix is based on



PrintABlok Base Bloks

by 3D Printing Professor



Ghost Bobblehead

by 3D Printy

Model files



snowman.stl

📄 v1

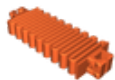

spring.stl

📄 v1

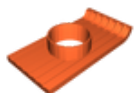

sled.stl

📄 version 1



base.stl

📄 version 1

License ©

This work is licensed under a
Creative Commons (4.0 International License)



Attribution—Noncommercial—Share Alike

- ✗ | Sharing without ATTRIBUTION
- ✓ | Remix Culture allowed
- ✗ | Commercial Use
- ✗ | Free Cultural Works
- ✗ | Meets Open Definition